

Wrought Copper and Wrought Copper Alloy Solder-Joint Drainage Fittings — DWV

AN AMERICAN NATIONAL STANDARD



The American Society of
Mechanical Engineers

Wrought Copper and Wrought Copper Alloy Solder-Joint Drainage Fittings — DWV

AN AMERICAN NATIONAL STANDARD



Two Park Avenue • New York, NY • 10016 USA

Date of Issuance: December 29, 2017

The next edition of this Standard is scheduled for publication in 2022.

ASME issues written replies to inquiries concerning interpretations of technical aspects of this Standard. Interpretations are published on the ASME Web site under the Committee Pages at <http://cstools.asme.org/> as they are issued.

Errata to codes and standards may be posted on the ASME Web site under the Committee Pages to provide corrections to incorrectly published items, or to correct typographical or grammatical errors in codes and standards. Such errata shall be used on the date posted.

The Committee Pages can be found at <http://cstools.asme.org/>. There is an option available to automatically receive an e-mail notification when errata are posted to a particular code or standard. This option can be found on the appropriate Committee Page after selecting “Errata” in the “Publication Information” section.

ASME is the registered trademark of The American Society of Mechanical Engineers.

This code or standard was developed under procedures accredited as meeting the criteria for American National Standards. The Standards Committee that approved the code or standard was balanced to assure that individuals from competent and concerned interests have had an opportunity to participate. The proposed code or standard was made available for public review and comment that provides an opportunity for additional public input from industry, academia, regulatory agencies, and the public-at-large.

ASME does not “approve,” “rate,” or “endorse” any item, construction, proprietary device, or activity.

ASME does not take any position with respect to the validity of any patent rights asserted in connection with any items mentioned in this document, and does not undertake to insure anyone utilizing a standard against liability for infringement of any applicable letters patent, nor assume any such liability. Users of a code or standard are expressly advised that determination of the validity of any such patent rights, and the risk of infringement of such rights, is entirely their own responsibility.

Participation by federal agency representative(s) or person(s) affiliated with industry is not to be interpreted as government or industry endorsement of this code or standard.

ASME accepts responsibility for only those interpretations of this document issued in accordance with the established ASME procedures and policies, which precludes the issuance of interpretations by individuals.

No part of this document may be reproduced in any form,
in an electronic retrieval system or otherwise,
without the prior written permission of the publisher.

The American Society of Mechanical Engineers
Two Park Avenue, New York, NY 10016-5990

Copyright © 2017 by
THE AMERICAN SOCIETY OF MECHANICAL ENGINEERS
All rights reserved
Printed in U.S.A.

CONTENTS

Foreword	v
Committee Roster.....	vi
Correspondence With the B16 Committee.....	vii
Summary of Changes.....	ix
List of Changes in Record Number Order	x
1 Scope	1
2 General	1
3 Description	1
4 Pitch (Slope)	1
5 Abbreviations	1
6 Component Size	1
7 Marking	2
8 Material	2
9 Laying Lengths	2
10 Ovality	2
11 Threaded Ends	2
12 Design of Threaded Ends	2
13 Alignment	2
14 Gaging	3
Mandatory Appendices	
I U.S. Customary Dimensions	14
II References	25
Nonmandatory Appendix	
A Quality System Program	26
Figure	
1 Size of Fittings	2
Tables	
1 Dimensions of Solder-Joint Ends	4
2 Dimensions of Threaded Ends — DWV	5
3 Dimensions of DWV Couplings, Extended Bushings, and Adapters	6
4 Dimensions of DWV Soil Pipe Adapters	7
5 Dimensions of DWV C × No-Hub Soil Pipe Adapters	8
6 Dimensions of DWV Elbows	9
7 Dimensions of DWV 45 deg Y's	10

8	Dimensions of DWV Tees	11
9	Dimensions of DWV Caps	11
10	Dimensions of DWV Vent Increasers	11
11	Dimensions of DWV Closet Flanges	12
12	Dimensions of DWV Trap Adapters	13
13	Dimensions of DWV Slip-Joint Ends	13
I-1	Dimensions of Solder-Joint Ends	15
I-2	Dimensions of Threaded Ends — DWV	16
I-3	Dimensions of DWV Couplings, Extended Bushings, and Adapters	17
I-4	Dimensions of DWV Soil Pipe Adapters	18
I-5	Dimensions of DWV C × No-Hub Soil Pipe Adapters	19
I-6	Dimensions of DWV Elbows	20
I-7	Dimensions of DWV 45 deg Y's	21
I-8	Dimensions of DWV Tees	22
I-9	Dimensions of DWV Caps	22
I-10	Dimensions of DWV Vent Increasers	22
I-11	Dimensions of DWV Closet Flanges	23
I-12	Dimensions of DWV Trap Adapters	24
I-13	Dimensions of DWV Slip-Joint Ends	24

FOREWORD

Standardization of cast and wrought solder-joint fittings was initiated in Subcommittee 11 of American Standards Association (ASA) Sectional Committee A40 on Plumbing Requirements and Equipment. Development work culminated in publication of ASA A40.3-1941.

In 1949, work on these fittings was transferred to Sectional Committee B16 of ASA, which established Subcommittee 9 (now Subcommittee J). The first standard developed was approved as ASA B16.18-1950, Cast Bronze Solder-Joint Fittings. A later joint effort of the Copper and Brass Research Association and the Manufacturers Standardization Society of the Valve and Fittings Industry (MSS) culminated in a standard on wrought fittings, ultimately approved as B16.22-1951.

Concurrently, recognizing the need for drainage fitting standards, an MSS task group developed the standard later approved as ASA B16.23-1953, Cast Bronze Solder-Joint Drainage Fittings, and a standard for wrought fittings was initially published as MSS SP-64-1961. A revision of that standard was submitted to Subcommittee 9 of B16 and was eventually approved as ASA B16.29-1966.

A revision was published [after reorganization of ASA as the American National Standards Institute (ANSI)] as ANSI B16.29-1973. In this edition, shorter solder cups were specified in larger sizes, since strength to contain pressure is not a factor. In 1979, Subcommittee I (formerly 9, now J) added metric dimensional equivalents and made other minor improvements. That revision was approved by ANSI, after approval by the Committee and secretariat organizations, as ANSI B16.29-1980.

In 1982, American National Standards Committee B16 was reorganized as an ASME Committee operating under procedures accredited by ANSI. The 1986 edition of the standard removed metric equivalents (not functionally applicable in the plumbing industry), updated the referenced standards, and incorporated editorial and format revisions. The 1994 edition removed inspection tolerance requirements, established minimum laying lengths, added soil pipe adapters, and incorporated editorial revisions. Following approval by the Standards Committee and ASME, approval as an American National Standard was given by ANSI on October 10, 1994, with the designator ASME B16.29-1994.

The 2001 edition of this Standard was revised to include Nonmandatory Appendix B, Quality System Program. Editorial revisions were made for the purpose of clarification. Following approval by the B16 Main Committee and ASME Supervisory Board, the Standard was approved as an American National Standard by ANSI on October 11, 2001.

In the 2007 edition, metric units were used as a primary reference unit while maintaining U.S. Customary units in either parenthetical or separate forms. In addition, several editorial revisions were made for clarity.

In the 2012 edition, references to ASME standards were revised to no longer list specific edition years; the latest edition of ASME publications applied unless stated otherwise. Following approval by the B16 Standards Committee and the ASME Supervisory Board, and after public review, the Standard was approved as an American National Standard by ANSI on August 23, 2012.

In this 2017 edition, provisions have been made to update verbiage and readings. Following approval by the ASME B16 Standards Committee, approval as an American National Standard was given by ANSI on September 7, 2017, with the new designation ASME B16.29-2017.

ASME B16 COMMITTEE

Standardization of Valves, Flanges, Fittings, and Gaskets

(The following is the roster of the Committee at the time of approval of this Standard.)

STANDARDS COMMITTEE OFFICERS

R. M. Bojarczuk, *Chair*
C. E. Davila, *Vice Chair*
C. R. Ramcharran, *Secretary*

STANDARDS COMMITTEE PERSONNEL

A. Appleton , Alloy Stainless Products Co., Inc.	R. C. Merrick , Fluor Enterprises
J. E. Barker , Dezurik Water Controls	M. L. Nayyar , NICE
K. Barron , Ward Manufacturing	W. H. Patrick , Dow Chemical Co.
D. C. Bayreuther , Metso Automation	D. W. Rahoi , CCM 2000
W. B. Bedesem , Consultant	C. R. Ramcharran , The American Society of Mechanical Engineers
R. M. Bojarczuk , ExxonMobil Research & Engineering Co.	D. F. Reid , VSP Technologies
A. M. Cheta , Qatar Shell GTL	R. A. Schmidt , Canadoil
M. A. Clark , NIBCO, Inc.	J. P. Tucker , Flowserve Corp.
G. A. Cuccio , Capitol Manufacturing Co.	F. R. Volgstadt , Volgstadt & Associates, Inc.
C. E. Davila , Crane Energy	F. Feng , <i>Delegate</i> , China Productivity Center For Machinery
J. D'Avanzo , Fluoroseal Valves	R. W. Barnes , <i>Contributing Member</i> , Anric Enterprises, Inc.
K. S. Felder , Valero Energy	P. V. Craig , <i>Contributing Member</i> , Jomar Group
D. R. Frikken , Becht Engineering Co., Inc.	B. G. Fabian , <i>Contributing Member</i> , Pennsylvania Machine Works
D. Hunt, Jr. , Fastenal	M. Katcher , <i>Contributing Member</i> , Haynes International
G. A. Jolly , Samshin Ltd.	A. G. Kireta, Jr. , <i>Contributing Member</i> , Copper Development Association, Inc.
E. J. Lain , Exelon Nuclear	
T. A. McMahon , Emerson Process Management	

SUBCOMMITTEE J — COPPER AND COPPER ALLOY FLANGES, FLANGED FITTINGS, AND SOLDER JOINT FITTINGS

A. G. Kitera, Jr. , <i>Chair</i> , Copper Development Association, Inc.	W. E. Chapin , Professional Code Consulting, LLC
M. A. Clark , <i>Vice Chair</i> , NIBCO, Inc.	D. R. Frikken , Becht Engineering Co.
E. Lawson , <i>Secretary</i> , The American Society of Mechanical Engineers	A. A. Knapp , A. Knapp & Associates
J. Oh , <i>Secretary</i> , The American Society of Mechanical Engineers	C. A. Mueller , Mueller Industries, Inc.
J. A. Ballanco , JB Engineering & Code Consulting	F. Shingleton , Viega, LLC
S. L. Cavanaugh , Cavanaugh Consulting	G. Morgan , <i>Alternate</i> , Viega, LLC

CORRESPONDENCE WITH THE B16 COMMITTEE

General. ASME Standards are developed and maintained with the intent to represent the consensus of concerned interests. As such, users of this Standard may interact with the Committee by requesting interpretations, proposing revisions or a case, and attending Committee meetings. Correspondence should be addressed to:

Secretary, B16 Standards Committee
The American Society of Mechanical Engineers
Two Park Avenue
New York, NY 10016-5990
<http://go.asme.org/Inquiry>

Proposing Revisions. Revisions are made periodically to the Standard to incorporate changes that appear necessary or desirable, as demonstrated by the experience gained from the application of the Standard. Approved revisions will be published periodically.

The Committee welcomes proposals for revisions to this Standard. Such proposals should be as specific as possible, citing the paragraph number(s), the proposed wording, and a detailed description of the reasons for the proposal, including any pertinent documentation.

Interpretations. Upon request, the B16 Standards Committee will render an interpretation of any requirement of the Standard. Interpretations can only be rendered in response to a written request sent to the Secretary of the B16 Standards Committee.

Requests for interpretation should preferably be submitted through the online Interpretation Submittal Form. The form is accessible at <http://go.asme.org/InterpretationRequest>. Upon submittal of the form, the Inquirer will receive an automatic e-mail confirming receipt.

If the Inquirer is unable to use the online form, he/she may e-mail the request to the Secretary of the B16 Standards Committee at SecretaryB16@asme.org, or mail it to the above address. The request for an interpretation should be clear and unambiguous. It is further recommended that the Inquirer submit his/her request in the following format:

Subject:	Cite the applicable paragraph number(s) and the topic of the inquiry in one or two words.
Edition:	Cite the applicable edition of the Standard for which the interpretation is being requested.
Question:	Phrase the question as a request for an interpretation of a specific requirement suitable for general understanding and use, not as a request for an approval of a proprietary design or situation. Please provide a condensed and precise question, composed in such a way that a "yes" or "no" reply is acceptable.
Proposed Reply(ies):	Provide a proposed reply(ies) in the form of "Yes" or "No," with explanation as needed. If entering replies to more than one question, please number the questions and replies.
Background Information:	Provide the Committee with any background information that will assist the Committee in understanding the inquiry. The Inquirer may also include any plans or drawings that are necessary to explain the question; however, they should not contain proprietary names or information.

Requests that are not in the format described above may be rewritten in the appropriate format by the Committee prior to being answered, which may inadvertently change the intent of the original request.

Moreover, ASME does not act as a consultant for specific engineering problems or for the general application or understanding of the Standard requirements. If, based on the inquiry information submitted, it is the opinion of the Committee that the Inquirer should seek assistance, the inquiry will be returned with the recommendation that such assistance be obtained.

ASME procedures provide for reconsideration of any interpretation when or if additional information that might affect an interpretation is available. Further, persons aggrieved by an interpretation may appeal to the cognizant ASME Committee or Subcommittee. ASME does not “approve,” “certify,” “rate,” or “endorse” any item, construction, proprietary device, or activity.

Attending Committee Meetings. The B16 Standards Committee regularly holds meetings and/or telephone conferences that are open to the public. Persons wishing to attend any meeting and/or telephone conference should contact the Secretary of the B16 Standards Committee.

ASME B16.29-2017

SUMMARY OF CHANGES

Following approval by the ASME B16 Committee and ASME, and after public review, ASME B16.29-2017 was approved by the American National Standards Institute on September 7, 2017.

ASME B16.29-2017 includes the following changes identified by a margin note, **(17)**. The Record Numbers listed below are explained in more detail in the “List of Changes in Record Number Order” following this Summary of Changes.

<i>Page</i>	<i>Location</i>	<i>Change (Record Number)</i>
7	Table 4	In the fourth column, fourth entry corrected by errata from “6” to “67” (17-1720)
25	Mandatory Appendix II	References revised (16-1636)

LIST OF CHANGES IN RECORD NUMBER ORDER

Record Number	Change
16-1636	References updated in Mandatory Appendix II.
17-1720	Table 4 value corrected by errata from “6” to “67.”

Wrought Copper and Wrought Copper Alloy Solder-Joint Drainage Fittings — DWV

1 SCOPE

This Standard for wrought copper and wrought copper alloy solder-joint drainage fittings, designed for use with copper drainage tube conforming to ASTM B306, covers the following:

- (a) description
- (b) pitch (slope)
- (c) abbreviations for end connections
- (d) sizes and method of designating openings for reducing fittings
- (e) marking
- (f) material
- (g) dimensions and tolerances

2 GENERAL

2.1 Convention

For determining conformance with this Standard, the convention for fixing significant digits where limits (maximum and minimum values) are specified shall be as defined in ASTM E29. This requires that an observed or calculated value be rounded off to the nearest unit in the last right-hand digit used for expressing the limit. Decimal values and tolerances do not imply a particular method of measurement.

2.2 Relevant Units

This Standard states values in both SI (metric) and U.S. Customary units. These systems of units are to be regarded separately as standard. Within the text, the U.S. Customary units are shown in parentheses or in separate tables that appear in [Mandatory Appendix I](#). The values stated in each system are not exact equivalents; therefore, it is required that each system of units be used independently of the other. Combining values from the two systems constitutes nonconformance with the Standard.

2.3 References

Codes, standards, and specifications, containing provisions to the extent referenced herein, constitute requirements of this Standard. These reference documents are listed in [Mandatory Appendix II](#).

2.4 Quality Systems

Guidelines relating to the product manufacturer's quality system programs are described in [Nonmandatory Appendix A](#).

3 DESCRIPTION

These fittings are designed for drainage and vent systems only, using the solder-joint method of connection. The fitting cups (C) are provided with stops so that the ends of the tube, when assembled, meet the stops. Sketches and designs of fittings are illustrative only. The dimensions specified herein shall govern in all cases.

4 PITCH (SLOPE)

All nominal 90-deg fittings shall be pitched to result in a slope of 0.20 mm/m (0.25 in./ft) (2%) of horizontal tube length with reference to a horizontal plane.

5 ABBREVIATIONS

The symbols shown below are used to designate the type of fitting end.

Symbols	Definitions
C	Solder-joint fitting end (internal) made to receive copper tube diameter
F	Internal American National Standard taper pipe thread, NPTI
FTG	Solder-joint fitting end (external) made to copper tube diameter
M	External American National Standard taper pipe thread, NPTE
NPSM	American National Standard free-fitting straight mechanical pipe thread
SJ	End of fitting formed to receive outside diameter tube size

6 COMPONENT SIZE

6.1 Nominal Size

As applied in this Standard, the use of the phrase "nominal size" followed by a dimensionless number is for the purpose of fitting end connection size identification.

6.1.1 Tube. The size designations for the fitting end configurations defined in [Table 1](#) ([Table I-1](#)) correspond to drainage tube sizes defined in ASTM B306.

Figure 1 Size of Fittings

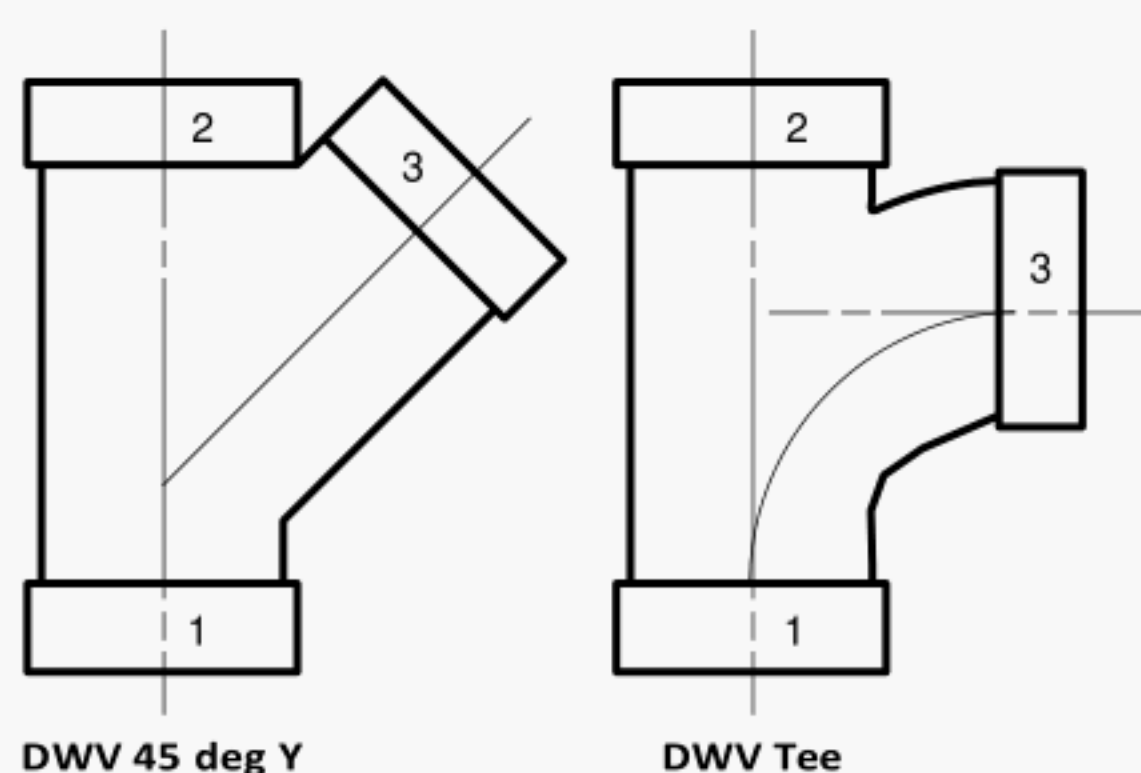

6.1.2 Pipe. The size designation of threaded fitting end configurations defined in Table 2 (Table I-2) corresponds to thread sizes defined in ASME B1.20.1.

6.2 Identification

Fittings shall be identified by the nominal size of the openings in the sequence illustrated in Figure 1.

7 MARKING

Each fitting shall be marked permanently and legibly with the manufacturer's name or trademark and with DWV (to indicate drain-waste-vent).

8 MATERIAL

Fittings shall be made of wrought copper or wrought copper alloy material having not less than 84% of copper content.

9 LAYING LENGTHS

Due to widely varying manufacturing processes, laying length dimensions of fittings are not standardized. Consult the manufacturer for these dimensions. Suggested dimensions, including laying lengths, for various fitting configurations are shown in Tables 3 through 13 (Tables I-3 through I-13).

10 OVALITY

Maximum ovality shall not exceed 1% of the maximum diameter shown in Table 1 (Table I-1). The average of the maximum and minimum diameters must be within the dimensions shown in the table.

11 THREADED ENDS

11.1 General

Fitting threads shall be right hand, conforming to ASME B1.20.1. They shall be American National Standard taper pipe threads (NPT), except for slip-joint ends, which shall have American National Standard free-fitting straight mechanical pipe threads (NPSM).

11.2 Chamfer

All internal threads shall be countersunk a distance not less than one-half the pitch of the thread at an angle of approximately 45 deg with the axis of the thread. All external threads shall be chamfered at an angle of 30 deg to 45 deg from the axis. Countersinking and chamfering shall be concentric with the threads. The length of threads shall be measured to include the countersink or chamfer.

11.3 Threading Tolerances

11.3.1 Internal Threads. Variations in NPT internal threading shall be limited to one turn large or one turn small from the gaging notch when using working gages. The reference point for gaging is the starting end of the fitting, provided the chamfer does not exceed the major diameter of the internal thread. When a chamfer on the internal thread exceeds this limit, the reference point becomes the last thread scratch on the chamfer cone.

11.3.2 External Threads. Variations in NPT external threading shall be limited to one turn large or one turn small from the gage face of ring when using working gages. The reference point for gaging is the end of the thread, provided the chamfer is not smaller than the minor diameter of the external thread. When a chamfer on the external thread exceeds this limit, the reference point becomes the last thread scratch on the chamfer cone.

12 DESIGN OF THREADED ENDS

External and internal threaded ends of fittings will be furnished with a polygon to facilitate installation.

13 ALIGNMENT

The maximum allowable variation in the angular alignment of all openings shall be 5 mm in 1 m (0.06 in. in 1 ft) (0.5%), other than in the direction of pitch (see section 4).

14 GAGING

14.1 Standard Gaging Method of Solder-Joint Ends

The standard method of gaging the diameter tolerances for external and internal ends shall be by use of plain plug and ring gages designed to hold the product within the limits established in [Table 1](#) ([Table I-1](#)).

14.2 Optional Gaging Method of Solder-Joint Ends

For gaging the diameter tolerance of external and internal ends, the manufacturer may use direct reading instruments instead of ring and plug gages as specified in [para. 14.1](#). When gaging the diameters of external and internal ends using direct reading instruments, refer to [section 10](#). In case of a dispute, ring/plug gages shall be used as the referee method.

Table 1 Dimensions of Solder-Joint Ends

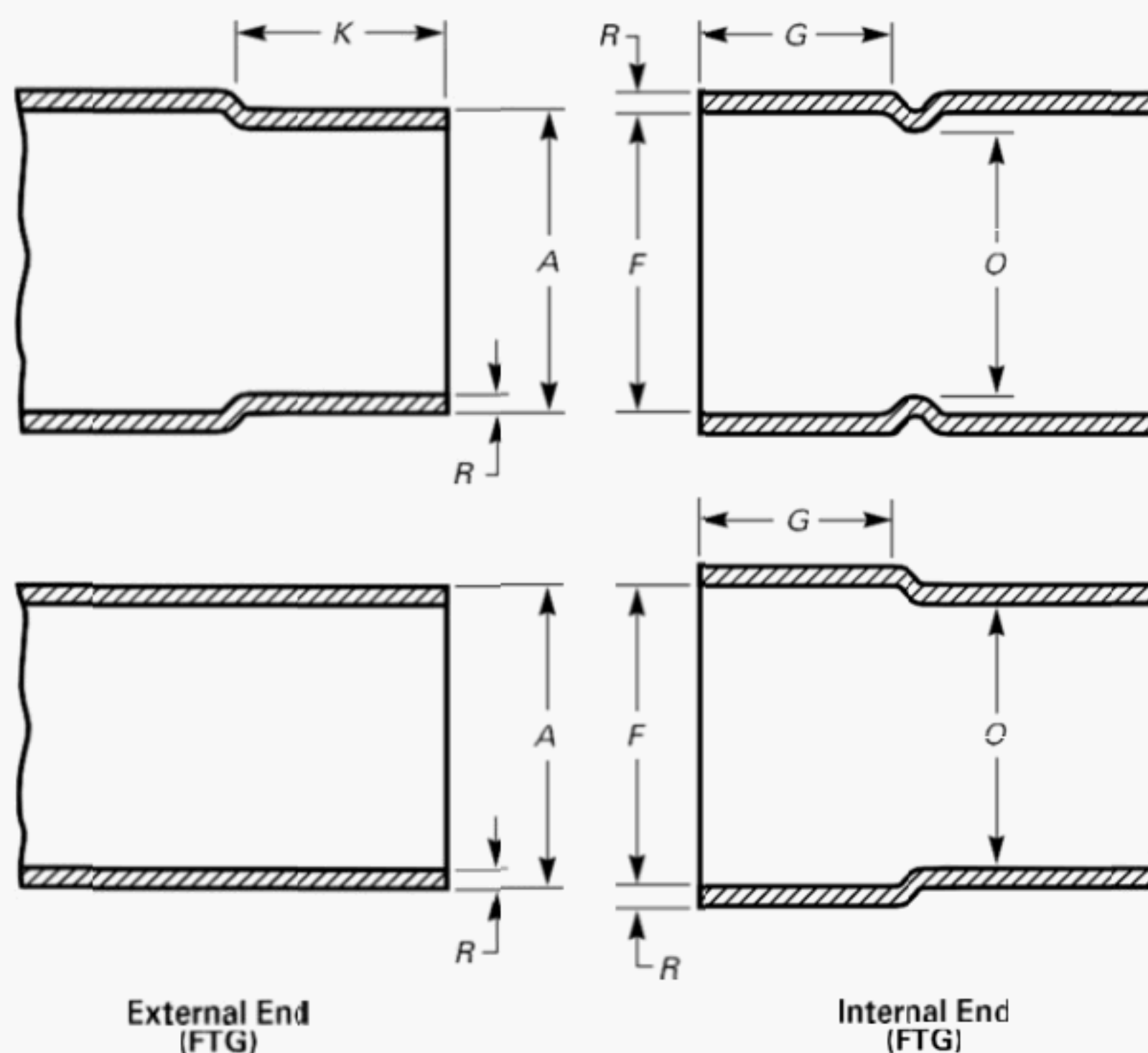

Nominal Tube Size [Note (1)]	External End			Internal End			Minimum Metal Thickness, <i>R</i> [Note (4)]	Minimum Inside Diameter of Fitting, <i>O</i> [Note (5)]
	Outside Diameter, <i>A</i> [Note (2)]		Minimum Length, <i>K</i> [Note (3)]	Inside Diameter, <i>F</i> [Note (2)]		Minimum Depth, <i>G</i> [Note (3)]		
	Min.	Max.		Min.	Max.			
1¼	34.85	34.98	14.22	35.00	35.10	12.70	1.02	32.77
1½	41.17	41.33	15.75	41.35	41.48	14.22	1.07	38.86
2	53.87	54.03	17.53	54.05	54.18	15.75	1.07	51.05
3	79.27	79.43	20.57	79.45	79.58	19.05	1.14	75.69
4	104.67	104.83	26.92	104.85	104.98	25.40	1.47	99.82

GENERAL NOTE: Dimensions are in millimeters.

NOTES:

- (1) For size designation of fitting, see [section 6](#).
- (2) See [section 10](#).
- (3) *K* dimensions of 11.2 mm, 12.7 mm, and 14.2 mm and *G* dimensions of 9.7 mm, 11.2 mm, and 12.7 mm, respectively, for sizes 1¼, 1½, and 2 are sound and acceptable from an engineering standpoint. However, the cup depths specified provide greater latitude in making accurate installations.
- (4) *R* dimension is based on DWV tubing, which is intended for aboveground use.
- (5) Inside diameter of fitting is based on Type M copper water tube (ASTM B88).

Table 2 Dimensions of Threaded Ends — DWV

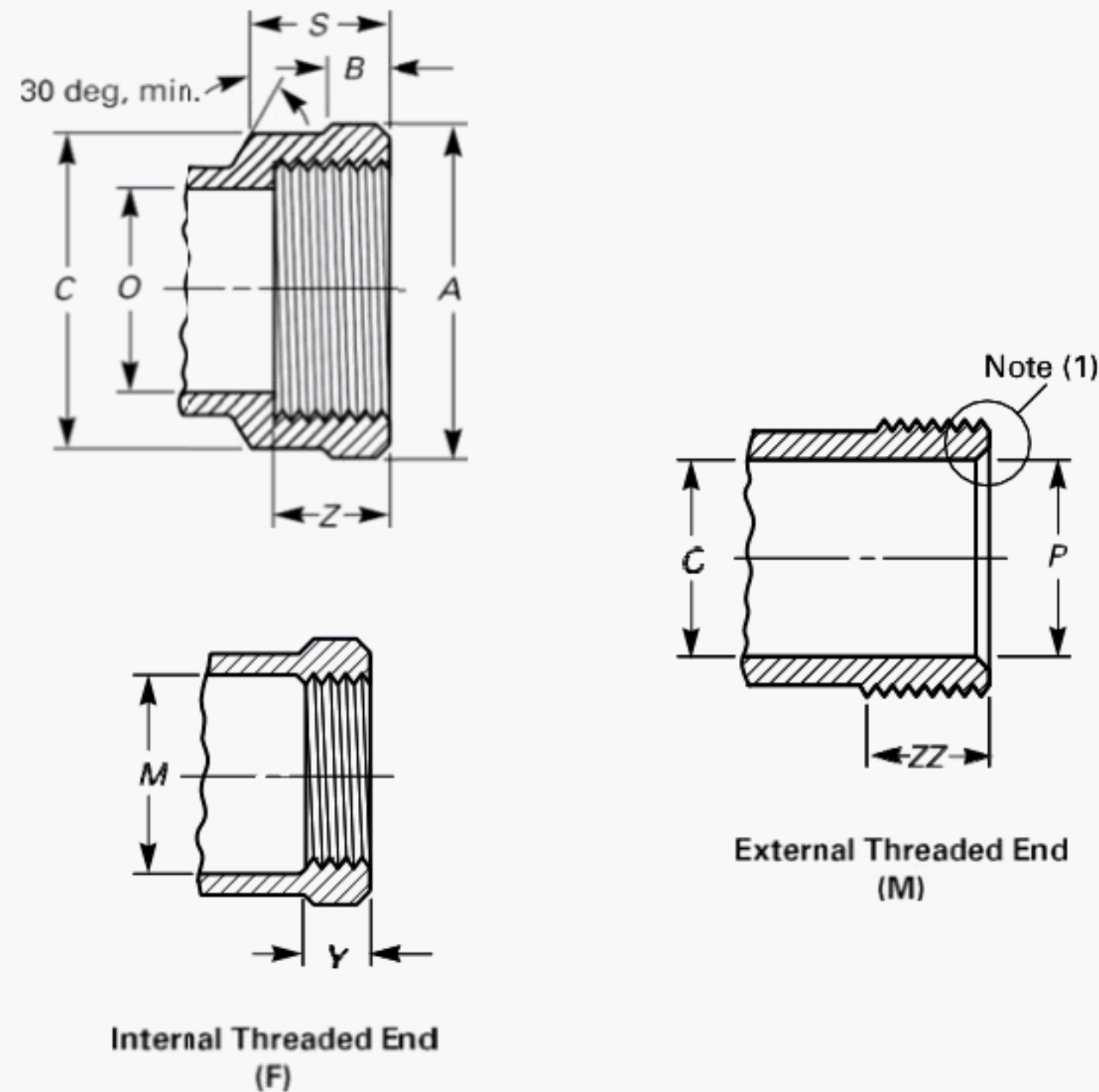

Nominal Thread Size [Note (4)]	Internal End [Note (2)]								External End [Not e (3)]		
	Minimum Diameter of Band or Across Flats of Polygon, <i>A</i>	Minimum Band Length, <i>B</i>	Minimum Diameter of Body Over Thread, <i>C</i>	Minimum Inside Diameter of Fitting, <i>O</i>	<i>M</i> , Min.	Minimum Length of Thread, <i>Y</i>	<i>S</i> , Min.	Minimum Depth of Bore, <i>Z</i>	Minimum Inside Diameter of Fitting, <i>O</i>	Maximum Thread End Bore, <i>P</i>	Minimum Length of Effective Thread, <i>ZZ</i>
1¼	45.2	8.6	43.7	32.8	42.2	10.7	18.3	17.5	32.8	34.8	18.0
1½	52.3	9.7	50.3	38.9	48.3	10.7	18.3	17.5	38.9	40.9	18.3
2	64.3	12.7	63.0	51.1	60.5	11.2	20.6	19.1	51.1	52.6	19.3
3	94.5	14.2	93.5	75.7	88.9	19.6	32.5	31.0	75.7	78.2	30.5

GENERAL NOTE: Dimensions are in millimeters.

NOTES:

- (1) 1¼, 1½, and 2 male threaded ends may have inside chamfer for slip-nut connections.
- (2) Internal threads shall be gaged ½ turn large to 1½ turn small from the gaging notch on the plug when using working gages.
- (3) External threads shall be gaged ½ turn small to 1½ turn large from the face of the ring when using working gages.
- (4) Thread size is as governed by ASME B1.20.1.

Table 3 Dimensions of DWV Couplings, Extended Bushings, and Adapters

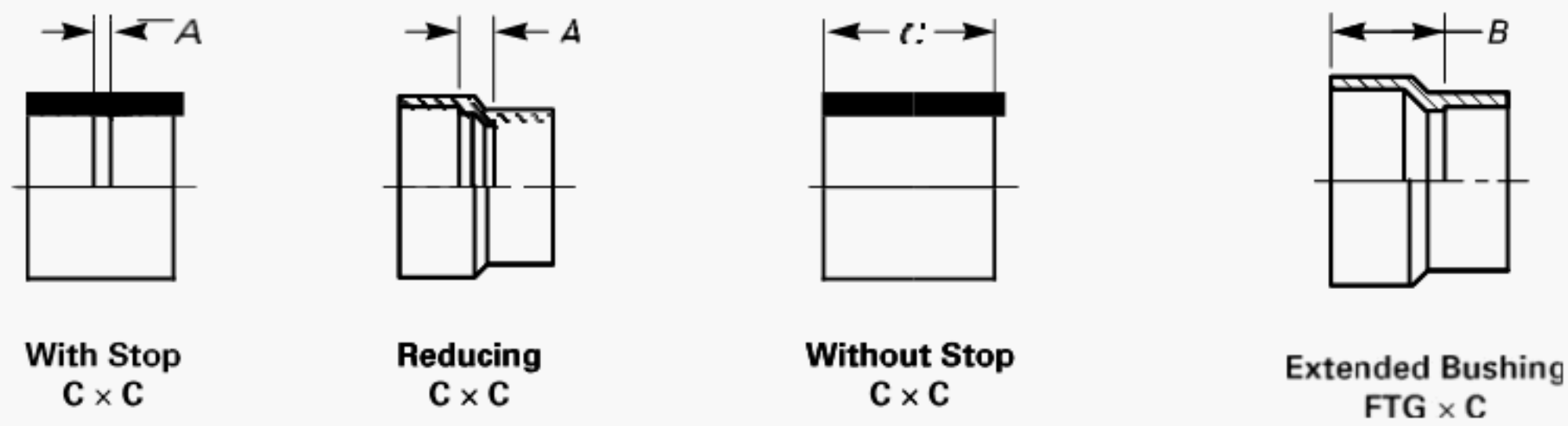
**DWV Couplings****DWV Adapters**

Nominal Thread or Tube Size	Minimum Couplings C × C, A	Minimum Coupling Reducer C × C, A	Minimum Couplings Without Stop C × C, C	Minimum Bushing Extended FTG × C, B	Adapters			
					Minimum C × F, B	Minimum C × M, B	Minimum FTG × F, C	Minimum FTG × M, C
1¼	1.5	...	25.4	...	18.5	21.8	34.5	...
1¼ × 1½	31.2
1½	1.5	...	28.4	...	18.5	21.8	37.6	42.9
1½ × 1¼	...	4.8	...	20.6	...	24.9
1½ × 2	37.6
2	1.5	...	31.8	...	21.8	21.8	40.9	...
2 × 1½	...	6.4	...	26.9
2 × 1¼	...	6.4	...	25.4	...	23.4
3	1.5	...	38.1	...	33.8	36.8	55.9	...
3 × 2	...	6.4	...	28.4
3 × 1½	...	7.9	...	28.4
3 × 1¼	...	7.9	...	30.2
4	1.5	...	50.8
4 × 3	...	9.7	...	36.6

GENERAL NOTE: Dimensions are in millimeters.

ø17p

Table 4 Dimensions of DWV Soil Pipe Adapters

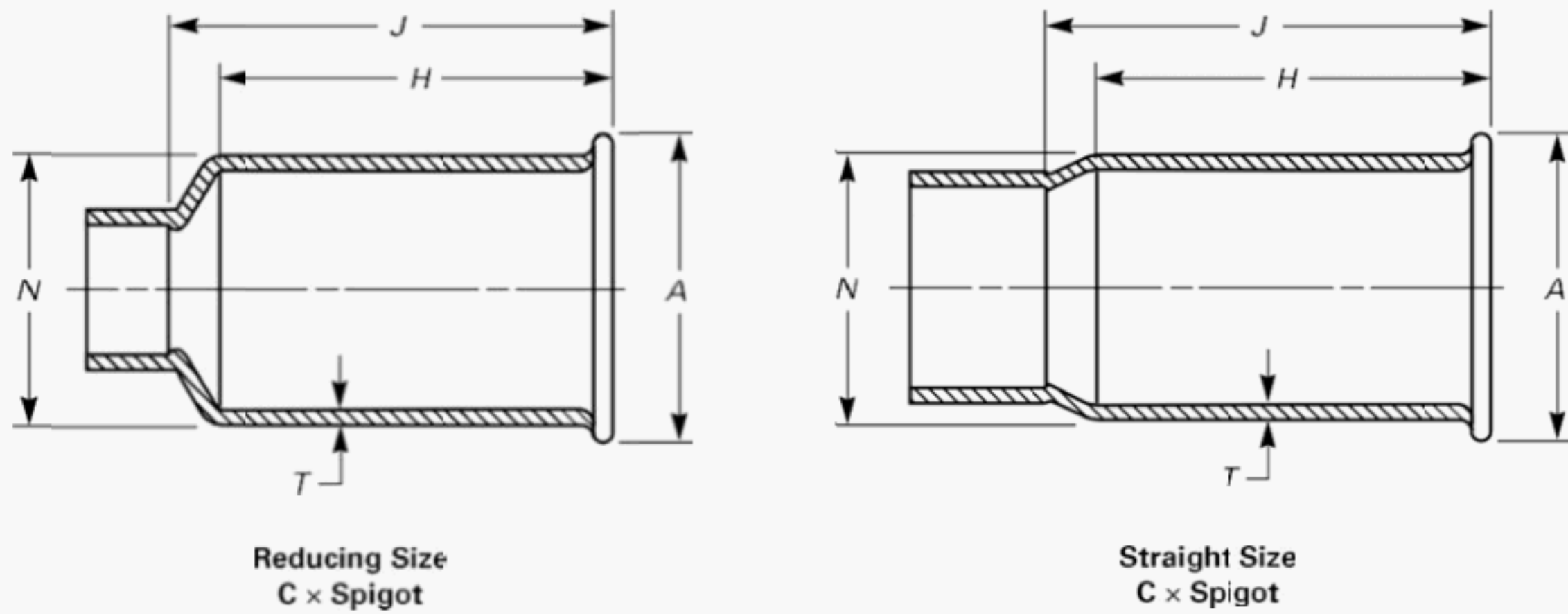

DWV Soil Pipe Adapters

Nominal Size	Dimensions					
	A , max.	A , min.	H , min.	J , min.	N	T , min.
2 x 2	69.9	68.3	60	64	62.2	1.37
1½ x 2	69.9	68.3	81	87	62.2	1.37
1¼ x 2	69.9	68.3	81	87	62.2	1.37
3 x 3	98.6	96.8	67	73	88.6	1.60
2 x 3	98.6	96.8	86	95	88.6	1.60
4 x 4	124.0	122.2	73	83	114.0	1.83
3 x 4	124.0	122.2	92	103	114.0	1.83

GENERAL NOTES:

- (a) Dimensions are in millimeters.
- (b) Dimensions are for extra-heavy weight soil pipe (reference ASTM A74). For service weight soil pipe, A and N nominal dimensions may be from 3 mm to 8 mm smaller than dimensions shown in table.

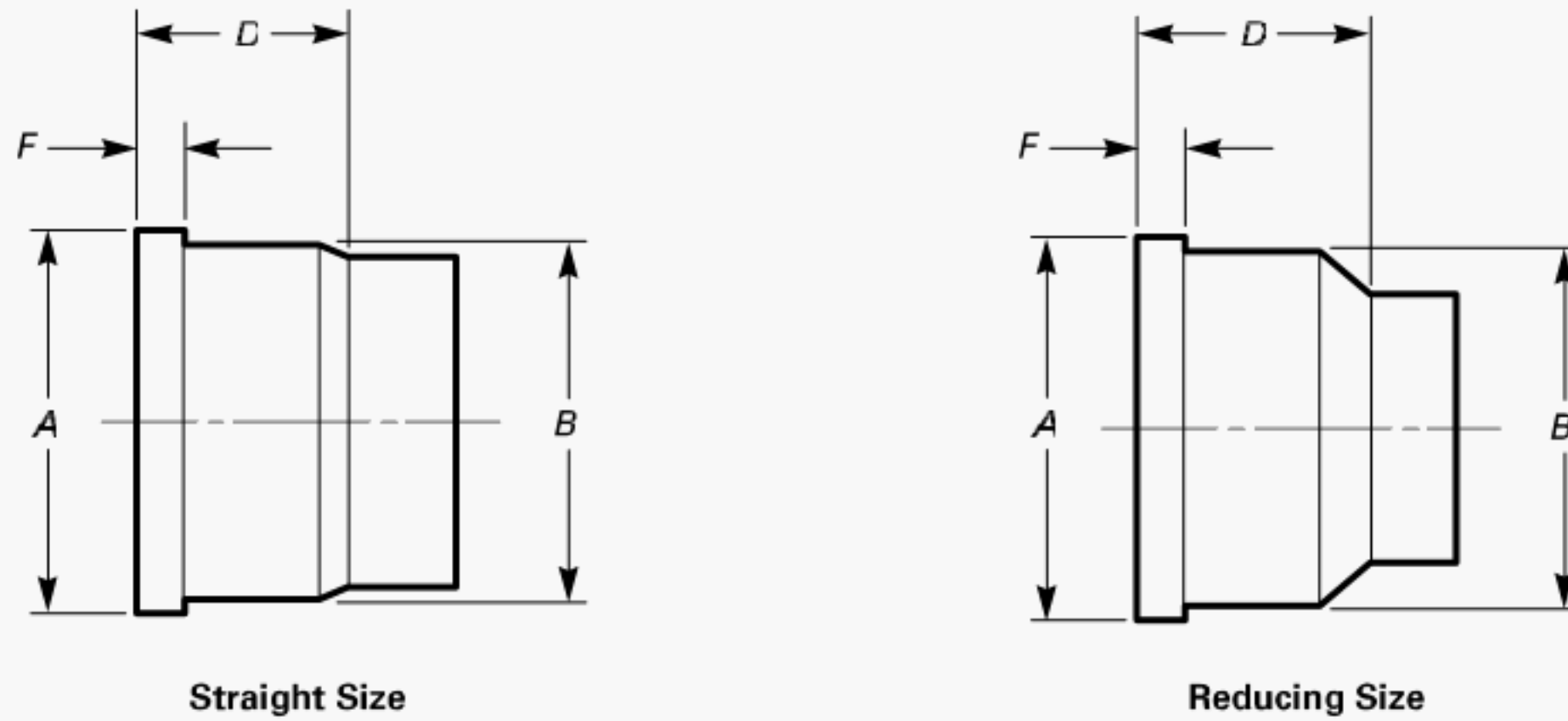
Table 5 Dimensions of DWV C × No-Hub Soil Pipe Adapters**DWV Soil Pipe Adapters – C × No-Hub
for Use With Stainless Steel Clamp and Elastomer Gasket**

Nominal Size	$A \pm 1.5$	$B \pm 1.5$	D , Min.	$F \pm \begin{smallmatrix} 3.3 \\ 0.00 \end{smallmatrix}$
2	60.5	58.7	31.0	6.4
1½ × 2	60.5	58.7	31.8	6.4
1¼ × 2	60.5	58.7	32.5	6.4
3	86.6	84.8	31.0	6.4
2 × 3	86.6	84.8	31.8	6.4
1½ × 3	86.6	84.8	32.5	6.4
4	112.8	111.3	31.0	7.9
3 × 4	112.8	111.3	31.8	7.9

GENERAL NOTE: Dimensions are in millimeters.

Table 6 Dimensions of DWV Elbows

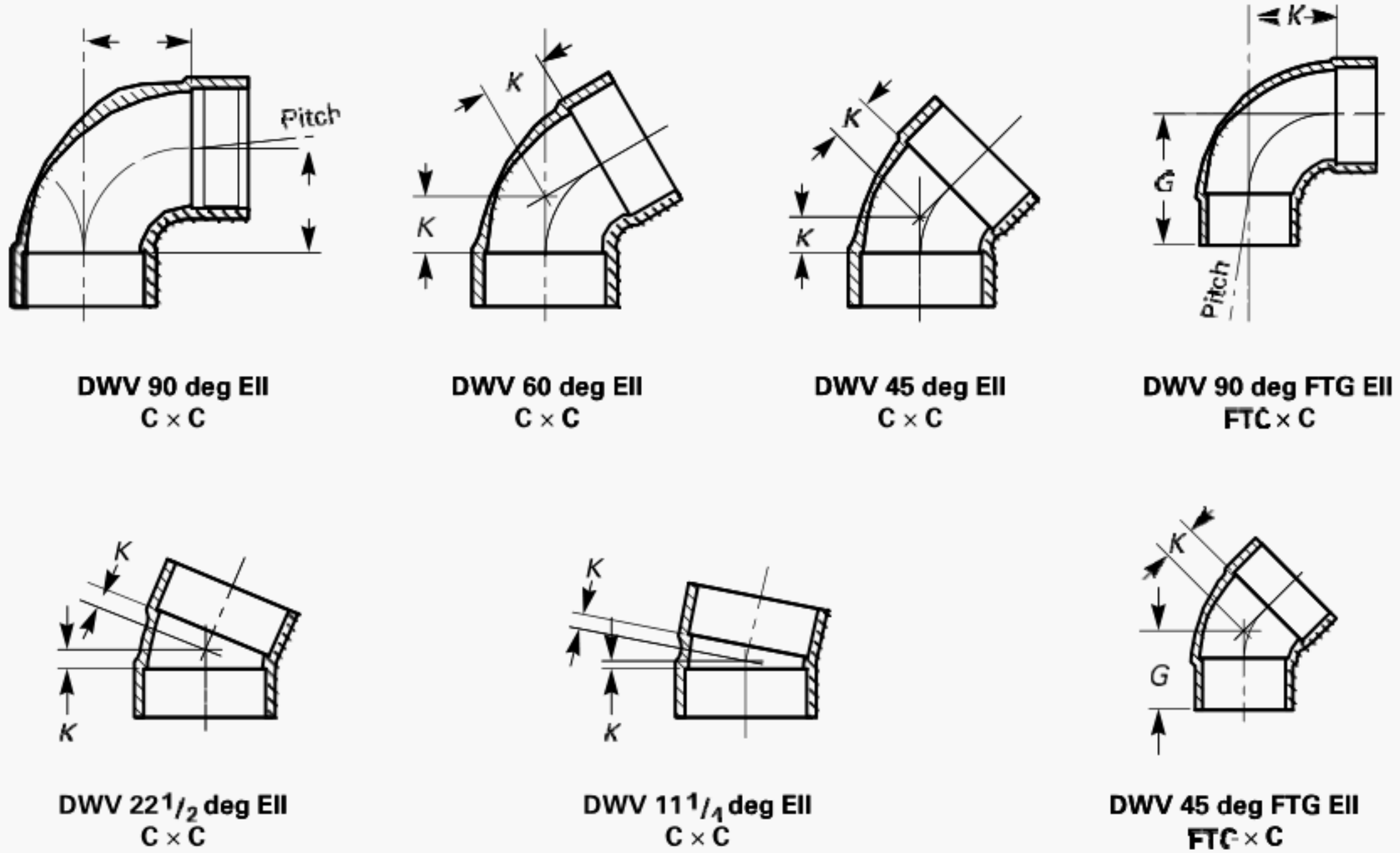

DWV Elbows

Nominal Tube Size, Min.	Dimensions								
	K for 90 deg $C \times C$	K for 60 deg $C \times C$	K for 45 deg $C \times C$	K for 22½ deg $C \times C$	K for 11¼ deg $C \times C$	K for 90 deg $FTG \times C$	G for 90 deg $FTG \times C$	K for 45 deg $FTG \times C$	G for 45 deg $FTG \times C$
1¼	28.2	15.5	10.7	2.8	1.0	28.2	42.4	10.7	24.9
1½	34.5	18.5	12.2	4.3	1.0	33.0	50.3	12.2	28.2
2	47.2	26.4	18.5	7.6	2.8	47.2	64.5	18.5	36.1
3	70.4	40.1	27.4	11.4	3.6	70.4	90.9	27.4	48.0
4	93.7	...	36.6	15.7	7.9	93.7	120.9	36.6	63.5

GENERAL NOTE: Dimensions are in millimeters.

Table 7 Dimensions of DWV 45 deg Y's

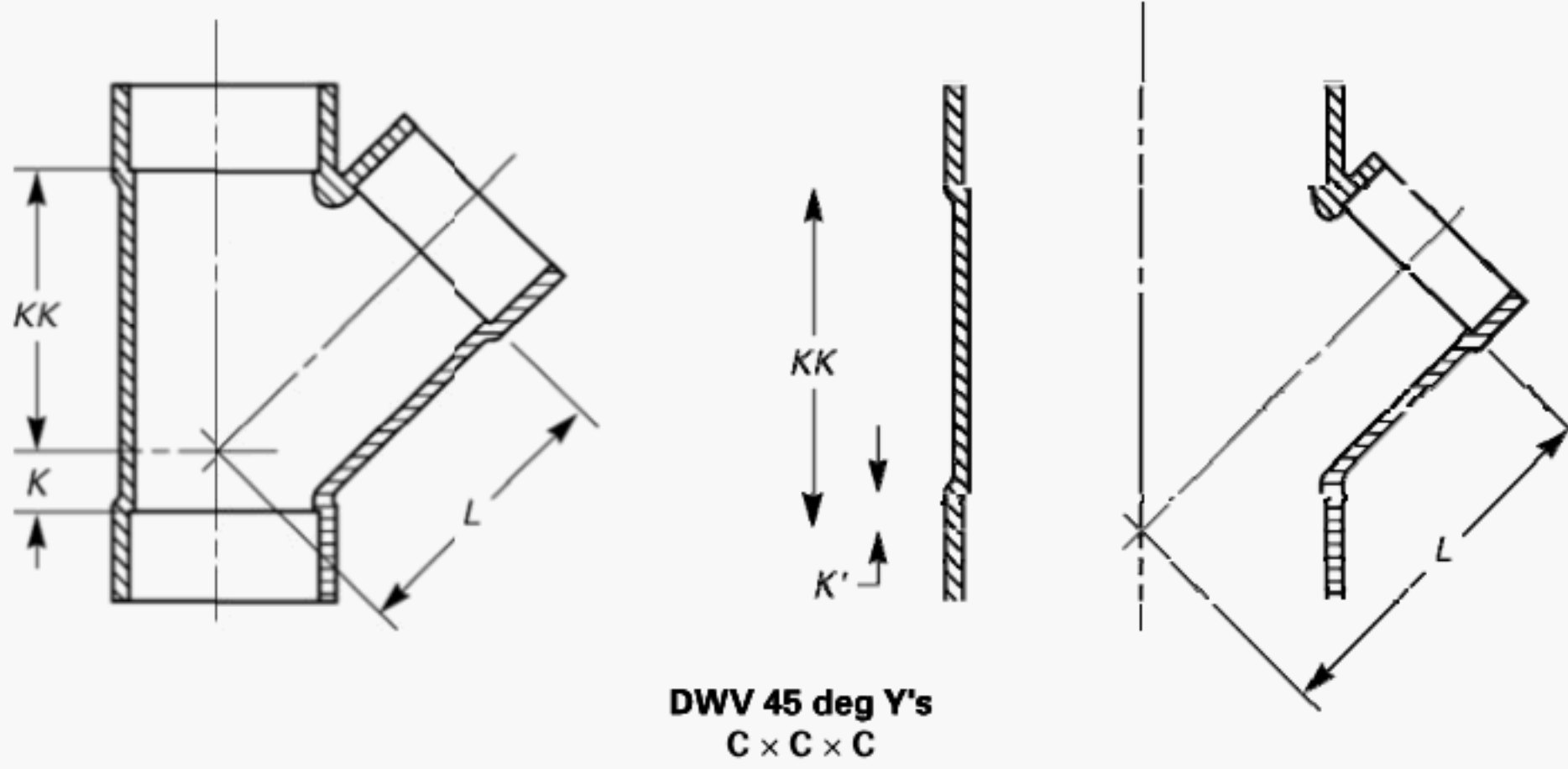

Nominal Tube Size	<i>K</i>	<i>K'</i>	<i>KK</i> , Min.	<i>L</i> , Min.
1¼	6	...	49.3	47.2
1½	8	...	58.7	56.6
1½ × 1½ × 1¼	4	...	53.8	51.8
1½ × 1¼ × 1½	8	...	60.5	53.6
1½ × 1¼ × 1¼	4	...	55.6	50.3
2	12	...	71.4	69.3
2 × 2 × 1½	3	...	63.5	64.5
2 × 2 × 1¼	0	...	58.7	59.9
2 × 1½ × 2	12	...	81.0	69.3
2 × 1½ × 1½	3	...	71.4	39.4
3	19	...	104.6	101.9
3 × 3 × 2	0	...	90.4	90.9
3 × 3 × 1½	...	3	81.0	84.6
3 × 3 × 1¼	...	5	71.4	78.2
4	24	...	136.7	133.6

GENERAL NOTE: Dimensions are in millimeters.

Table 8 Dimensions of DWV Tees

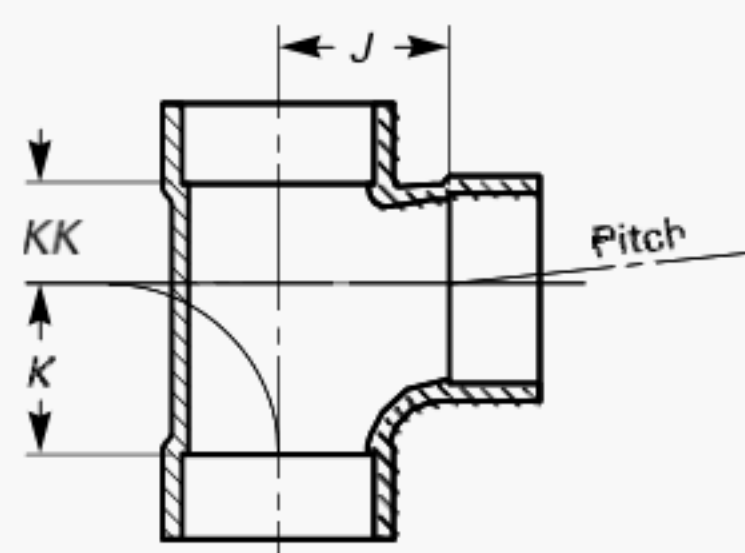
DWV Tees
C × C × C

Nominal Tube Size	J, Min.	K, Min.	KK, Min.
1¼	26.7	26.4	19.1
1½	33.0	33.0	20.6
1½ × 1½ × 1¼	29.7	26.4	20.6
1½ × 1¼ × 1½	34.5	34.5	23.9
1½ × 1¼ × 1¼	31.2	28.2	23.9
2	42.4	45.7	26.9
2 × 2 × 1½	37.6	31.2	22.4
2 × 2 × 1¼	36.1	26.4	19.1
2 × 1½ × 2	42.9	45.7	33.3
2 × 1½ × 1½	37.6	33.0	30.2
3	63.8	70.4	42.9
3 × 3 × 2	54.4	45.0	28.7
3 × 3 × 1½	49.5	32.3	23.9
3 × 3 × 1¼	48.0	25.7	20.6
4	95.5	95.5	52.3

GENERAL NOTE: Dimensions are in millimeters.

Table 9 Dimensions of DWV Caps

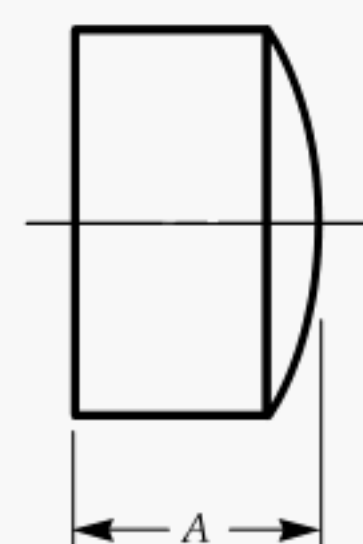
DWV Caps
C

Nominal Tube Size	A
1¼	18
1½	19
2	21

GENERAL NOTE: Dimensions are in millimeters.

Table 10 Dimensions of DWV Vent Increasers

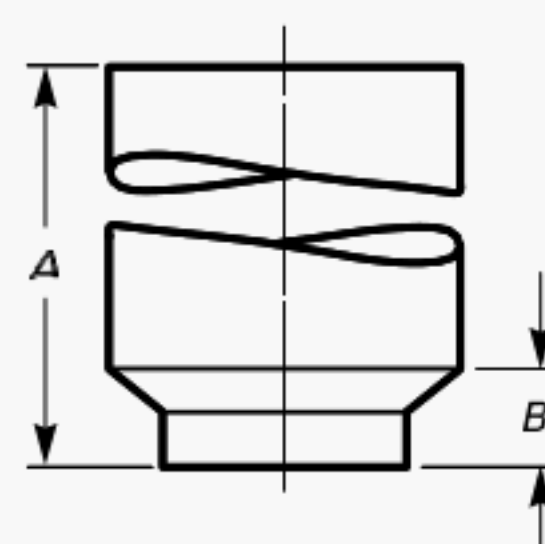
DWV Vent Increasers
C × FTG

Nominal Tube Size	A	B, Max.
3 × 4 × 18	457	76
3 × 4 × 24	610	76
3 × 4 × 30	762	76

GENERAL NOTE: Dimensions are in millimeters.

Table 11 Dimensions of DWV Closet Flanges

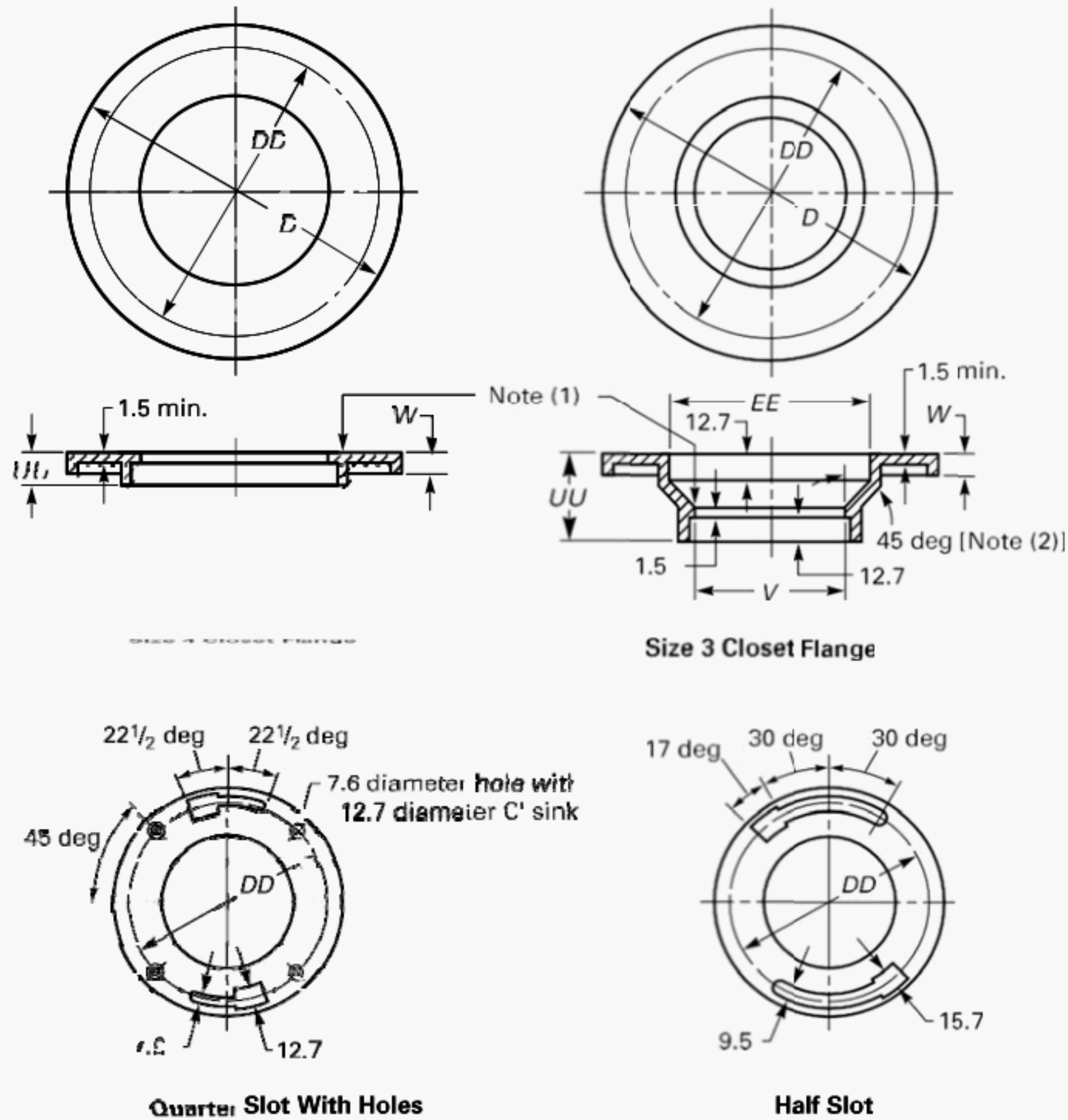

Size 3 Closet Flange

Quarter Slot With Holes

Half Slot

ed Slot Arrangements

Nominal Size	D, Min.	DD	EE	UU, Min.	V, Min. [Note (3)]	W
3	171.5	152	105	39.6	74.7	6.4
4	171.5	152	...	15.7	...	6.4

GENERAL NOTE: Dimensions are in millimeters.

NOTES:

- (1) Tube stop optional.
- (2) 45-deg angle may be extended to face of flange.
- (3) For flange with tube stop.

Table 12 Dimensions of DWV Trap Adapters

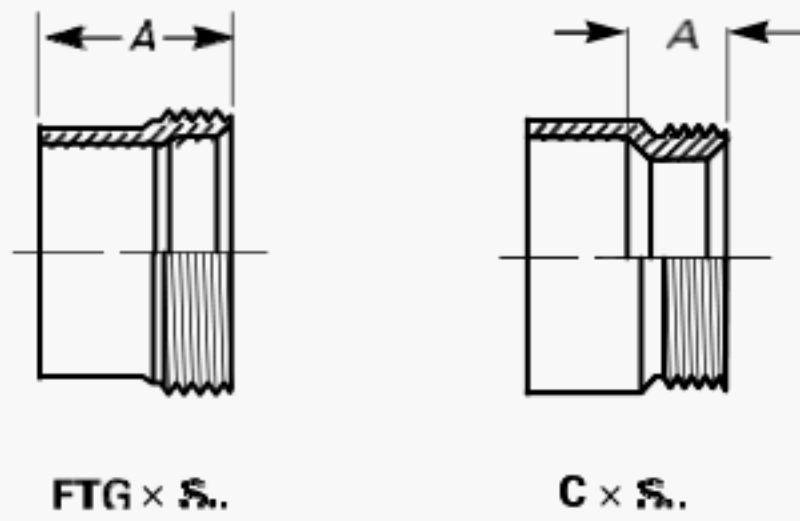

Nominal Size	FTG x SJ, A	C x SJ, A
1¼	27.7	12.7
1½	29.5	12.7
1½ x 1¼	30.2	15.7

GENERAL NOTE: Dimensions are in millimeters.

Table 13 Dimensions of DWV Slip-Joint Ends

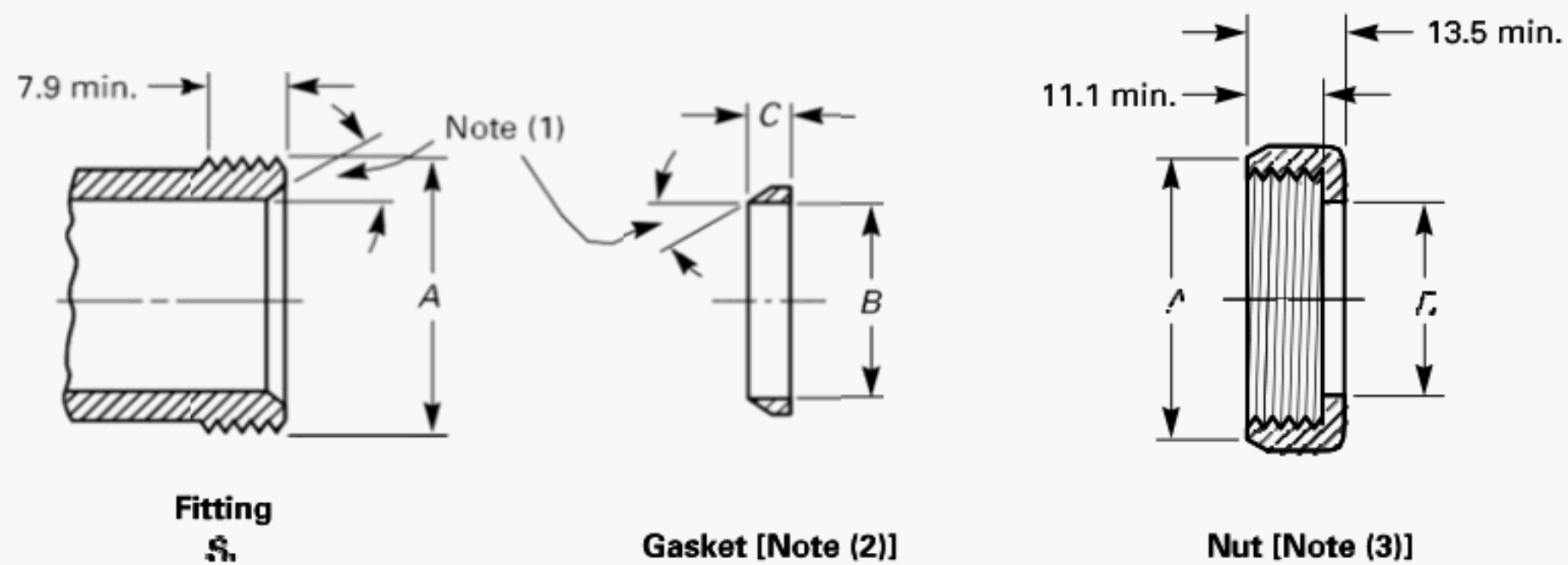

Nominal Size	Diameter of Thread, A	Gasket		Nut
		Nominal Inside Diameter of Gasket, B	Minimum Length of Gasket, C	Nominal Nut Hole Diameter, D
1¼	1¼ NPSM	32.0	4.1	32.5
1½	1½ NPSM	38.4	4.8	38.9

GENERAL NOTE: Dimensions are in millimeters.

NOTES:

- (1) Angles must be equal.
 (2) Gasket to be pliable, not subject to aging or drying out.
 (3) Nut may be any material specified in [section 8](#) or other suitable nonferrous alloy.

MANDATORY APPENDIX I U.S. CUSTOMARY DIMENSIONS

This Mandatory Appendix provides tables of the standard inch dimensions for fittings ([Tables I-1](#) through [I-13](#)).

Table I-1 Dimensions of Solder-Joint Ends

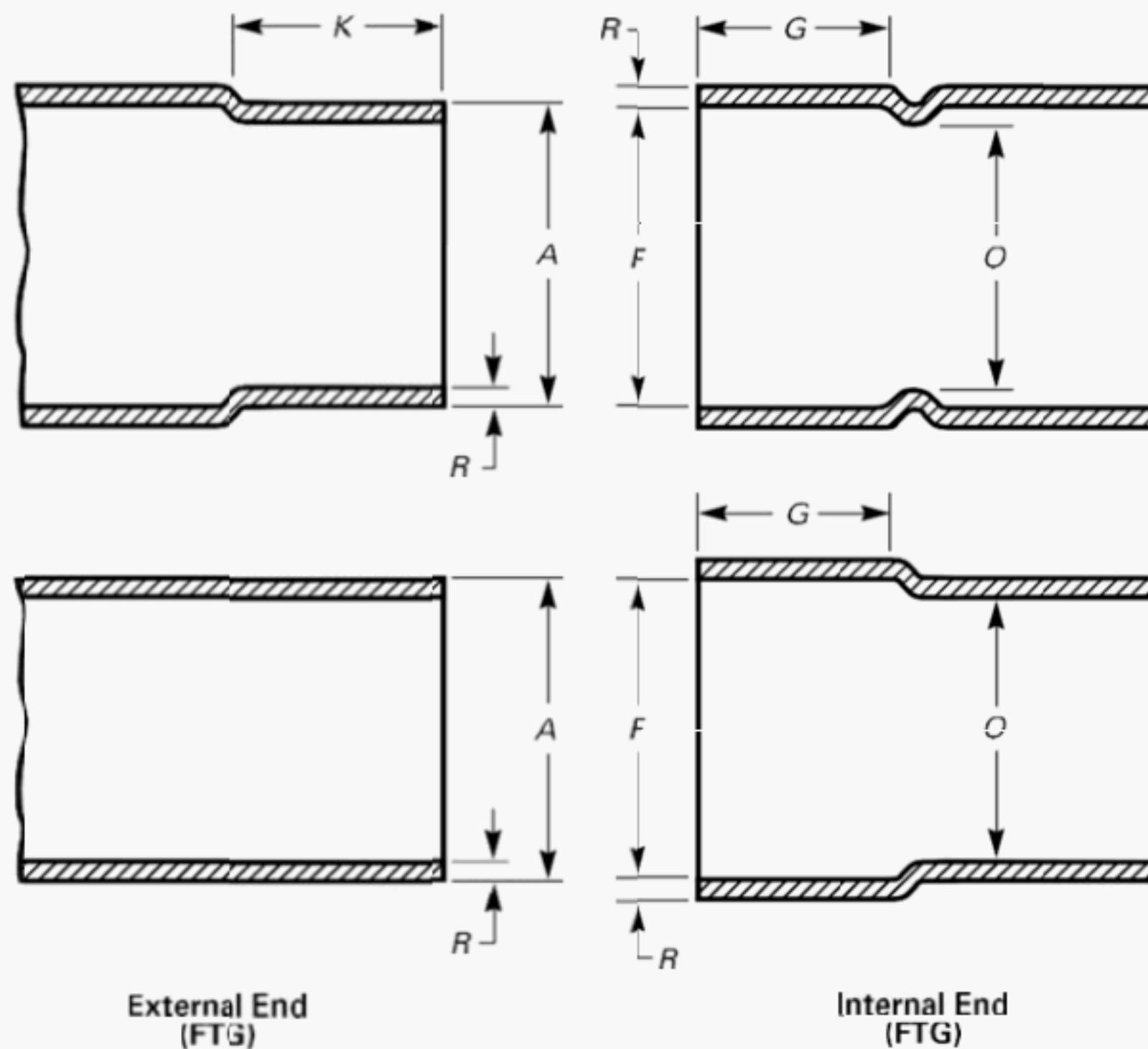

Nominal Tube Size [Note (1)]	External End			Internal End			Minimum Metal Thickness, <i>R</i> [Note (4)]	Minimum Inside Diameter of Fitting, <i>O</i> [Note (5)]
	Outside Diameter, <i>A</i> [Note (2)]		Minimum Length, <i>K</i> [Note (3)]	Inside Diameter, <i>F</i> [Note (2)]		Minimum Depth, <i>G</i> [Note (3)]		
	Min.	Max.		Min.	Max.			
1¼	1.372	1.377	0.56	1.378	1.382	0.50	0.040	1.29
1½	1.621	1.627	0.62	1.628	1.633	0.56	0.042	1.53
2	2.121	2.127	0.69	2.128	2.133	0.62	0.042	2.01
3	3.121	3.127	0.81	3.128	3.133	0.75	0.045	2.98
4	4.121	4.127	1.06	4.128	4.133	1.00	0.058	3.93

GENERAL NOTE: Dimensions are in inches.

NOTES:

- (1) For size designation of fitting, see [section 6](#).
- (2) See [section 10](#).
- (3) *K* dimensions of 0.44 in., 0.50 in., and 0.56 in. and *G* dimensions of 0.38 in., 0.44 in., and 0.50 in., respectively, for sizes 1¼, 1½, and 2 are sound and acceptable from an engineering standpoint. However, the cup depths specified provide greater latitude in making accurate installations.
- (4) *R* dimension is based on DWV tubing, which is intended for aboveground use.
- (5) Inside diameter of fitting is based on Type M copper water tube (ASTM B88).

Table I-2 Dimensions of Threaded Ends — DWV

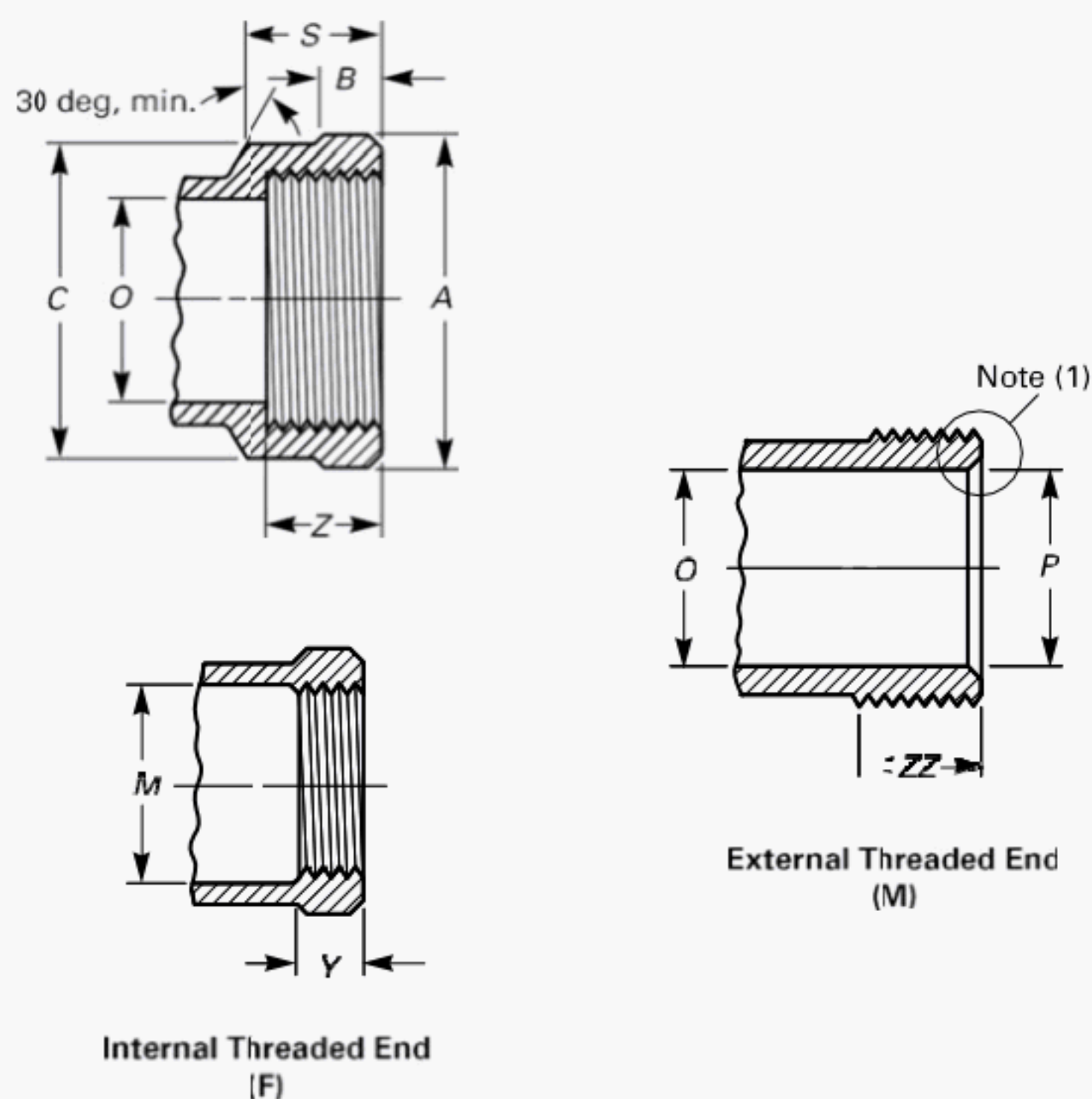

Nominal Thread Size [Note (4)]	Internal End [Note (2)]								External End [Note (3)]		
	Minimum Diameter of Band	Minimum Band Length, <i>B</i>	Minimum Diameter of Body Over Thread, <i>C</i>	Minimum Inside Diameter of Fitting, <i>O</i>	<i>M</i> , Min.	Minimum Length of Thread, <i>Y</i>	<i>S</i> , Min.	Minimum Depth of Bore, <i>Z</i>	Minimum Inside Diameter of Fitting, <i>O</i>	Maximum Thread End Bore, <i>P</i>	Minimum Length of Effective Thread, <i>ZZ</i>
	or Across Flats of Polygon, <i>A</i>										
1¼	1.78	0.34	1.72	1.29	1.66	0.42	0.72	0.69	1.29	1.37	0.71
1½	2.06	0.38	1.98	1.53	1.90	0.42	0.72	0.69	1.53	1.61	0.72
2	2.53	0.50	2.48	2.01	2.38	0.44	0.81	0.75	2.01	2.07	0.76
3	3.72	0.56	3.68	2.98	3.50	0.77	1.28	1.22	2.98	3.08	1.20

GENERAL NOTE: Dimensions are in inches.

NOTES:

- (1) 1¼, 1½, and 2 male threaded ends may have inside chamfer for slip-nut connections.
- (2) Internal threads shall be gaged ½ turn large to 1½ turn small from the gaging notch on the plug when using working gages.
- (3) External threads shall be gaged ½ turn small to 1½ turn large from the face of the ring when using working gages.
- (4) Thread size is as governed by ASME B1.20.1.

Table I-3 Dimensions of DWV Couplings, Extended Bushings, and Adapters

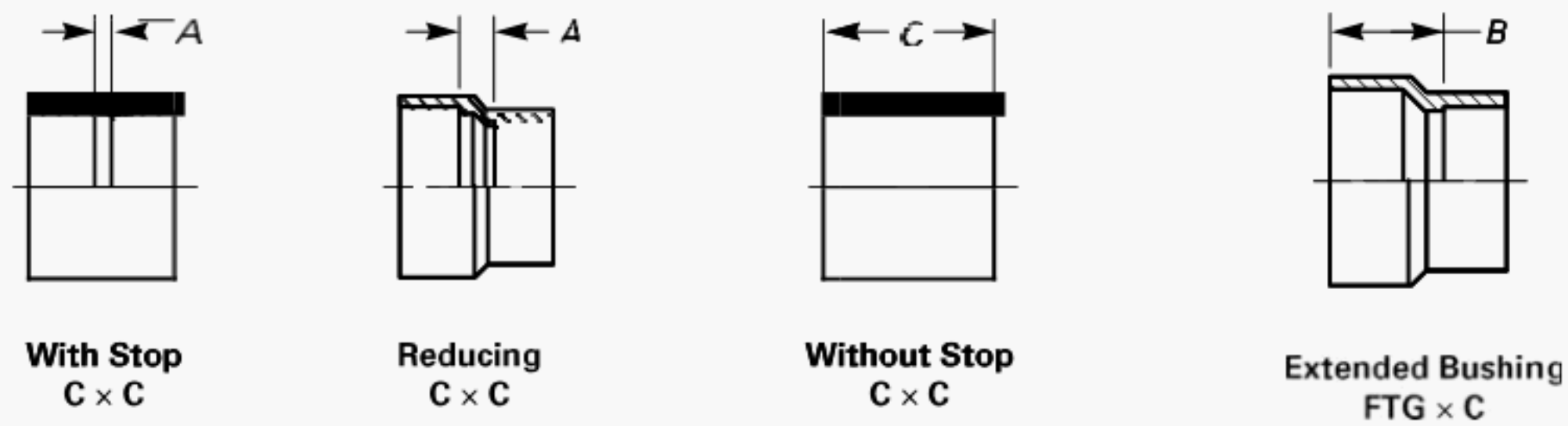

DWV Couplings

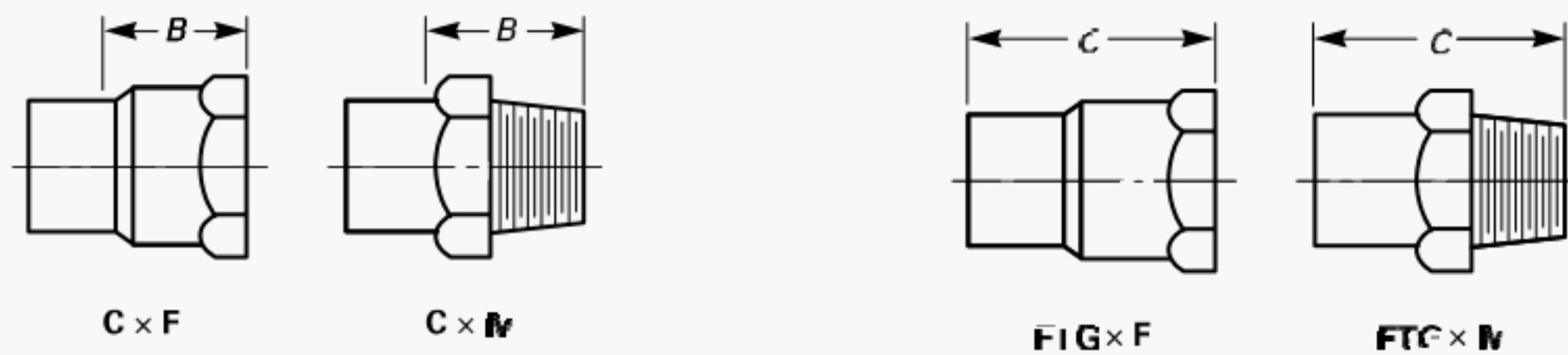

DWV Adapters

Nominal Thread or Tube Size	Minimum Couplings C × C, A	Minimum Coupling Reducer C × C, A	Minimum Couplings Without Stop C × C, C	Minimum Bushing Extended FTG × C, B	Adapters			
					Minimum C × F, B	Minimum C × M, B	Minimum FTG × F, C	Minimum FTG × M, C
1¼	0.06	...	1.00	...	0.73	0.86	1.36	...
1¼ × 1½	1.23
1½	0.06	...	1.12	...	0.73	0.86	1.48	1.69
1½ × 1¼	...	0.19	...	0.81	...	0.98
1½ × 2	1.48
2	0.06	...	1.25	...	0.86	0.86	1.61	...
2 × 1½	...	0.25	...	1.06
2 × 1¼	...	0.25	...	1.00	...	0.92
3	0.06	...	1.50	...	1.33	1.45	2.20	...
3 × 2	...	0.25	...	1.12
3 × 1½	...	0.31	...	1.12
3 × 1¼	...	0.31	...	1.19
4	0.06	...	2.00
4 × 3	...	0.38	...	1.44

GENERAL NOTE: Dimensions are in inches.

Table I-4 Dimensions of DWV Soil Pipe Adapters

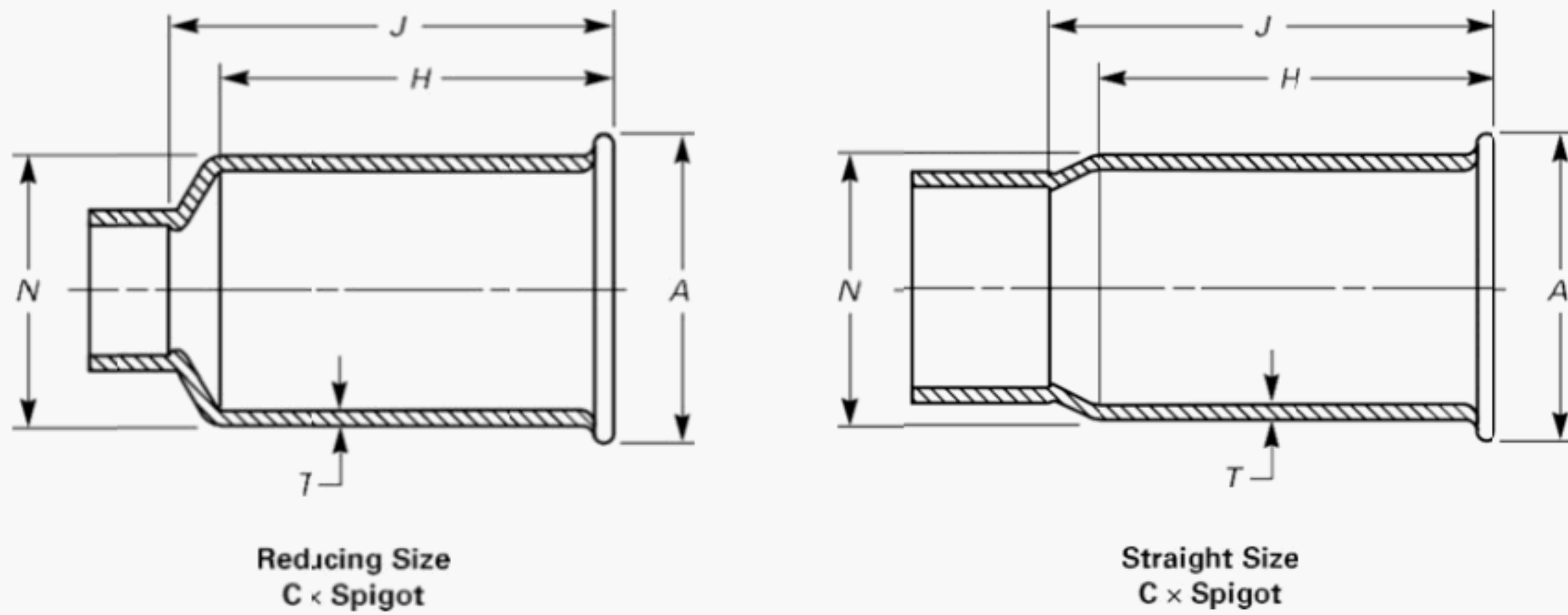

DWV Soil Pipe Adapters

Nominal Size	Dimensions					
	A , max.	A , min.	H , min.	J , min.	N	T , min.
2×2	2.75	2.69	2.36	2.50	2.45	0.054
$1\frac{1}{2} \times 2$	2.75	2.69	3.17	3.44	2.45	0.054
$1\frac{1}{4} \times 2$	2.75	2.69	3.17	3.44	2.45	0.054
3×3	3.88	3.81	2.64	2.88	3.49	0.063
2×3	3.88	3.81	3.39	3.75	3.49	0.063
4×4	4.88	4.81	2.88	3.25	4.49	0.072
3×4	4.88	4.81	3.63	4.06	4.49	0.072

GENERAL NOTES:

- (a) Dimensions are in inches.
- (b) Dimensions are for extra-heavy weight soil pipe (reference ASTM A74). For service weight soil pipe, A and N nominal dimensions may be from $\frac{1}{8}$ in. to $\frac{5}{16}$ in. smaller than dimensions shown in table.

Table I-5 Dimensions of DWV C × No-Hub Soil Pipe Adapters

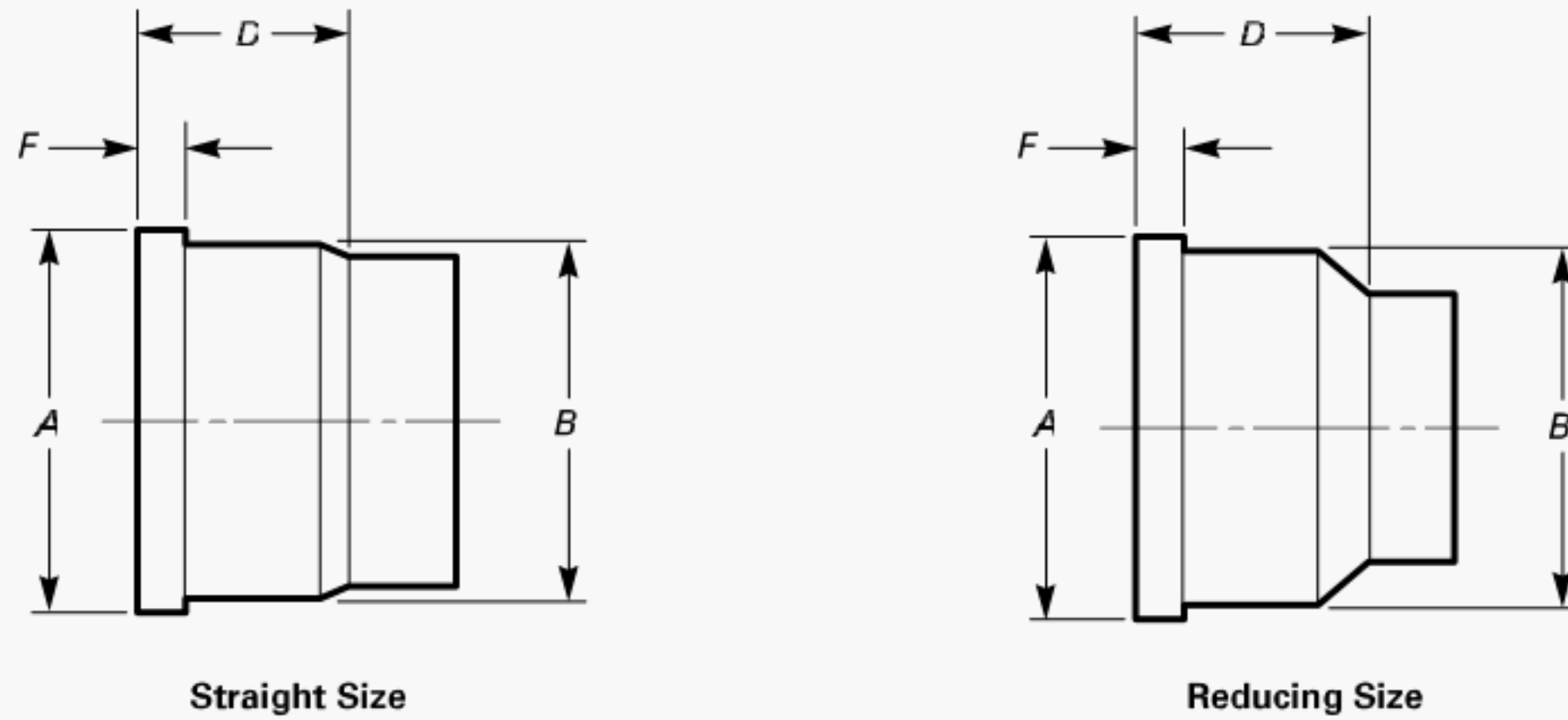

**DWV Soil Pipe Adapters – C × No-Hub
for Use With Stainless Steel Clamp and Elastomer Gasket**

Nominal Size	$A \pm 0.06$	$B \pm 0.06$	D , Min.	$F \begin{smallmatrix} \pm 0.13 \\ 0.00 \end{smallmatrix}$
2	2.38	2.31	1.22	0.25
1½ × 2	2.38	2.31	1.25	0.25
1¼ × 2	2.38	2.31	1.28	0.25
3	3.41	3.34	1.22	0.25
2 × 3	3.41	3.34	1.25	0.25
1½ × 3	3.41	3.34	1.28	0.25
4	4.44	4.38	1.22	0.31
3 × 4	4.44	4.38	1.25	0.31

GENERAL NOTE: Dimensions are in inches.

Table I-6 Dimensions of DWV Elbows

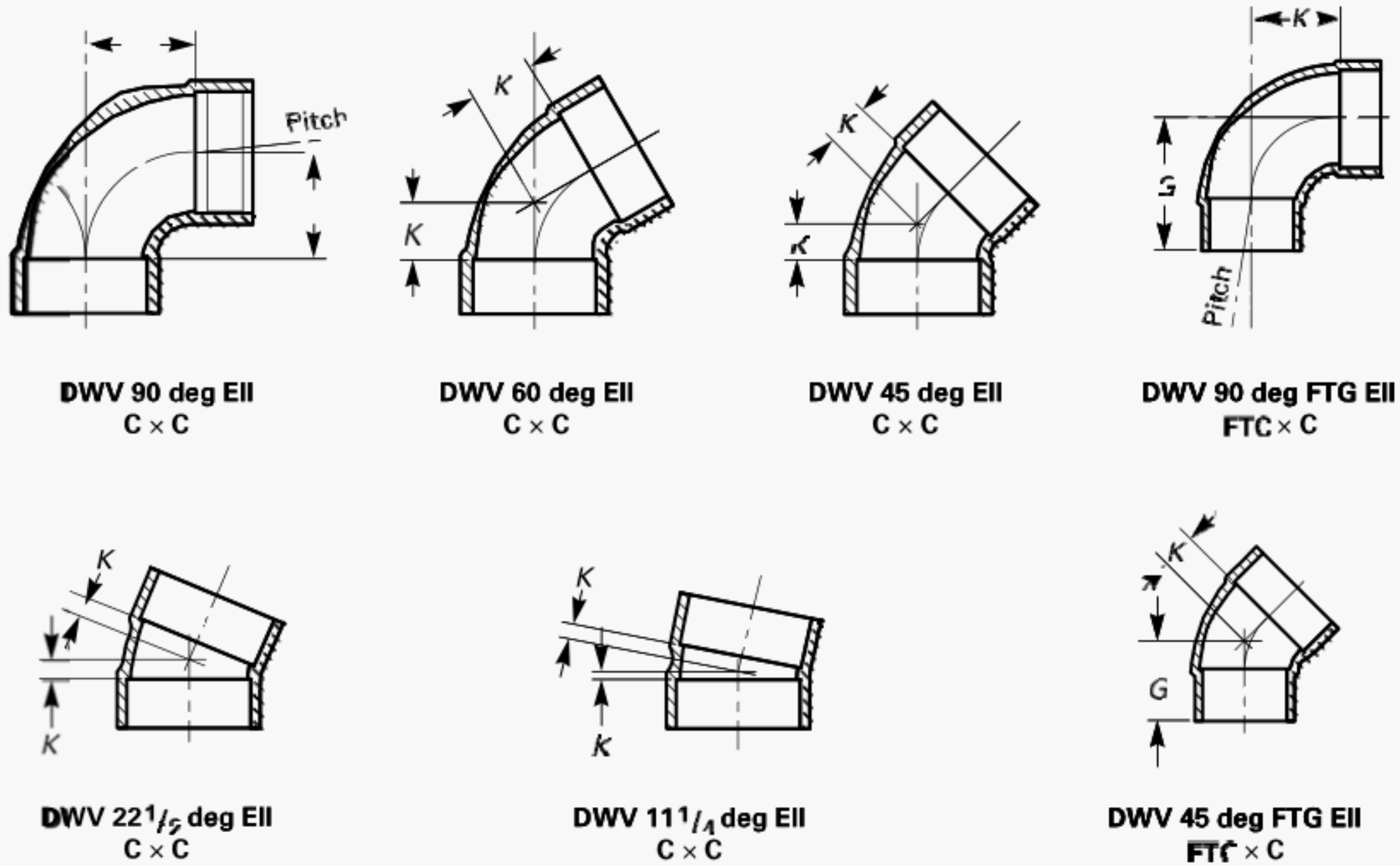

DWV Elbows

Nominal Tube Size, Min.	Dimensions								
	K for 90 deg $C \times C$	K for 60 deg $C \times C$	K for 45 deg $C \times C$	K for 22 $\frac{1}{2}$ deg $C \times C$	K for 11 $\frac{1}{4}$ deg $C \times C$	K for 90 deg $FTG \times C$	G for 90 deg $FTG \times C$	K for 45 deg $FTG \times C$	G for 45 deg $FTG \times C$
1 $\frac{1}{4}$	1.11	0.61	0.42	0.11	0.04	1.11	1.67	0.42	0.98
1 $\frac{1}{2}$	1.36	0.73	0.48	0.17	0.04	1.30	1.98	0.48	1.11
2	1.86	1.04	0.73	0.30	0.11	1.86	2.54	0.73	1.42
3	2.77	1.58	1.08	0.45	0.14	2.77	3.58	1.08	1.89
4	3.69	...	1.44	0.62	0.31	3.69	4.76	1.44	2.50

GENERAL NOTE: Dimensions are in inches.

Table I-7 Dimensions of DWV 45 deg Y's

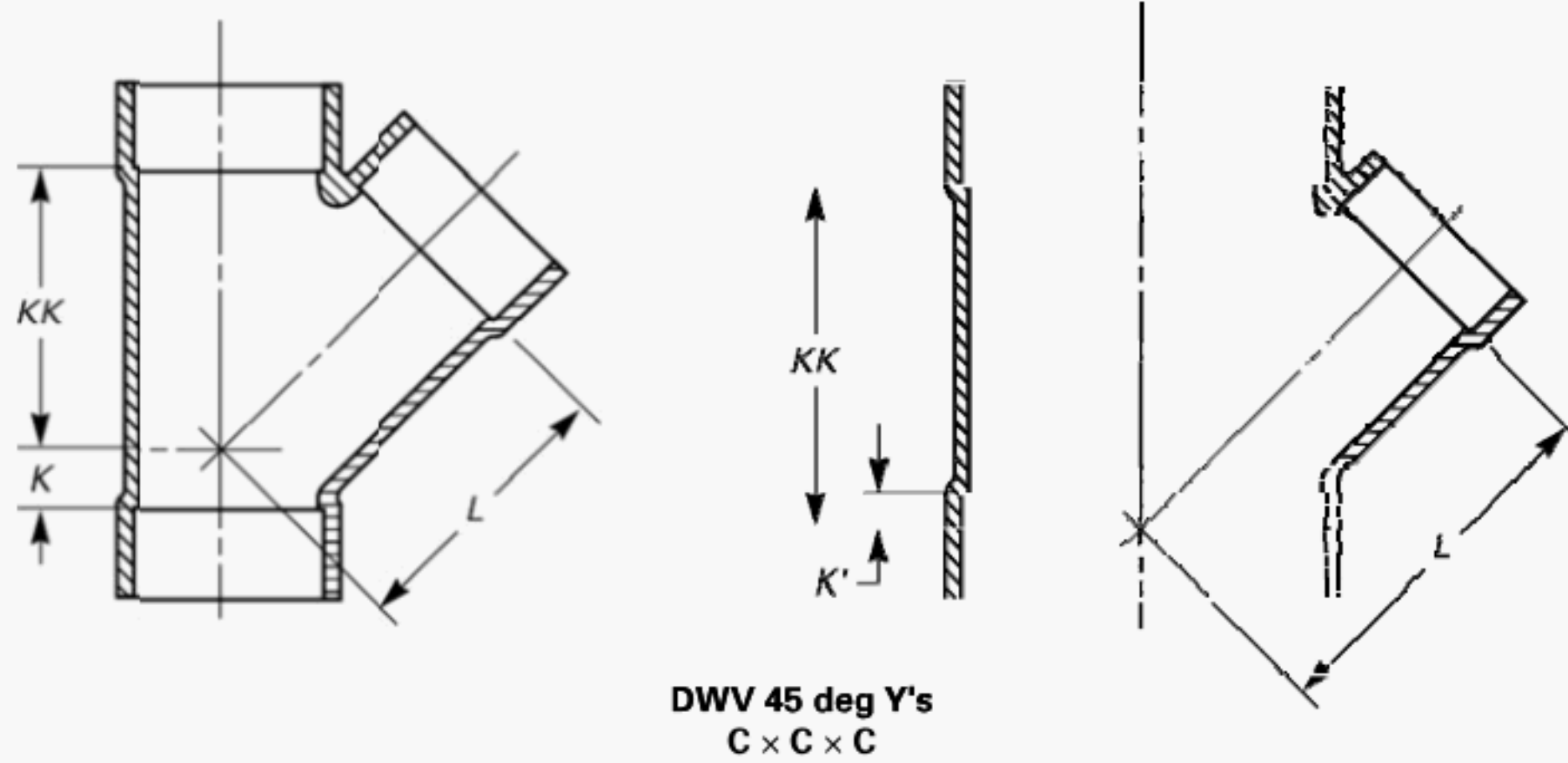

Nominal Tube Size	K	K'	KK, Min.	L, Min.
1¼	0.23	...	1.94	1.86
1½	0.30	...	2.31	2.23
1½ × 1½ × 1¼	0.17	...	2.12	2.04
1½ × 1¼ × 1½	0.30	...	2.38	2.11
1½ × 1¼ × 1¼	0.17	...	2.19	1.98
2	0.48	...	2.81	2.73
2 × 2 × 1½	0.11	...	2.50	2.54
2 × 2 × 1¼	0	...	2.31	2.36
2 × 1½ × 2	0.48	...	3.19	2.73
2 × 1½ × 1½	0.11	...	2.81	1.55
3	0.73	...	4.12	4.01
3 × 3 × 2	0	...	3.56	3.58
3 × 3 × 1½	...	0.13	3.19	3.33
3 × 3 × 1¼	...	0.19	2.81	3.08
4	0.94	...	5.38	5.26

GENERAL NOTE: Dimensions are in inches.

Table I-8 Dimensions of DWV Tees

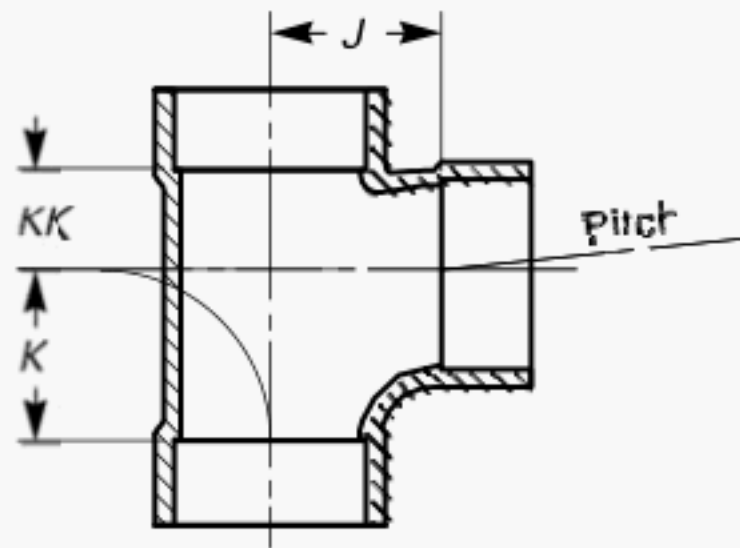
DWV Tees
C × C × C

Nominal Tube Size	J, Min.	K, Min.	KK, Min.
1¼	1.05	1.04	0.75
1½	1.30	1.30	0.81
1½ × 1½ × 1¼	1.17	1.04	0.81
1½ × 1¼ × 1½	1.36	1.36	0.94
1½ × 1¼ × 1¼	1.23	1.11	0.94
2	1.67	1.80	1.06
2 × 2 × 1½	1.48	1.23	0.88
2 × 2 × 1¼	1.42	1.04	0.75
2 × 1½ × 2	1.69	1.80	1.31
2 × 1½ × 1½	1.48	1.30	1.19
3	2.51	2.77	1.69
3 × 3 × 2	2.14	1.77	1.13
3 × 3 × 1½	1.95	1.27	0.94
3 × 3 × 1¼	1.89	1.01	0.81
4	3.76	3.76	2.06

GENERAL NOTE: Dimensions are in inches.

Table I-9 Dimensions of DWV Caps

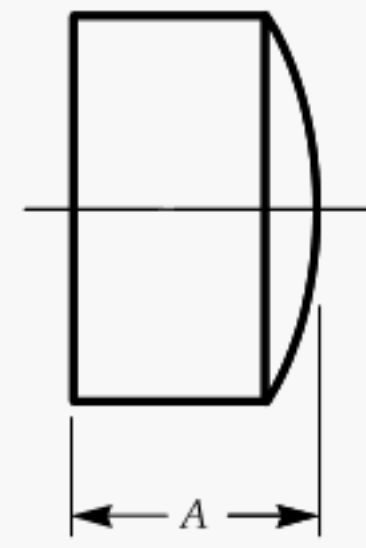
DWV Caps
C

Nominal Tube Size	A
1¼	0.69
1½	0.75
2	0.81

GENERAL NOTE: Dimensions are in inches.

Table I-10 Dimensions of DWV Vent Increasers

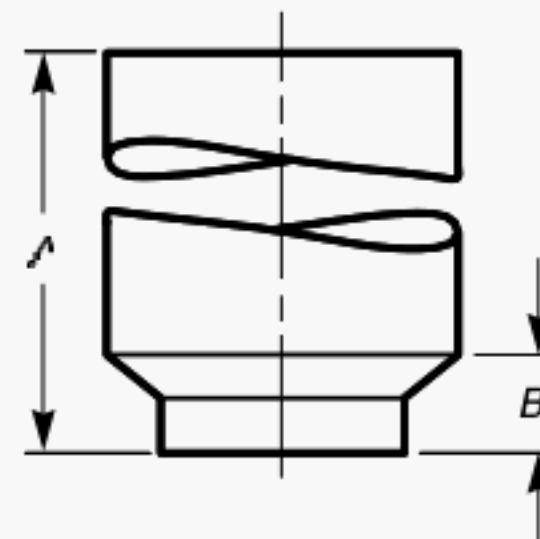
DWV Vent Increasers
C × FTG

Nominal Tube Size	A	B, Max.
3 × 4 × 18	18	3
3 × 4 × 24	24	3
3 × 3 × 30	30	3

GENERAL NOTE: Dimensions are in inches.

Table I-11 Dimensions of DWV Closet Flanges

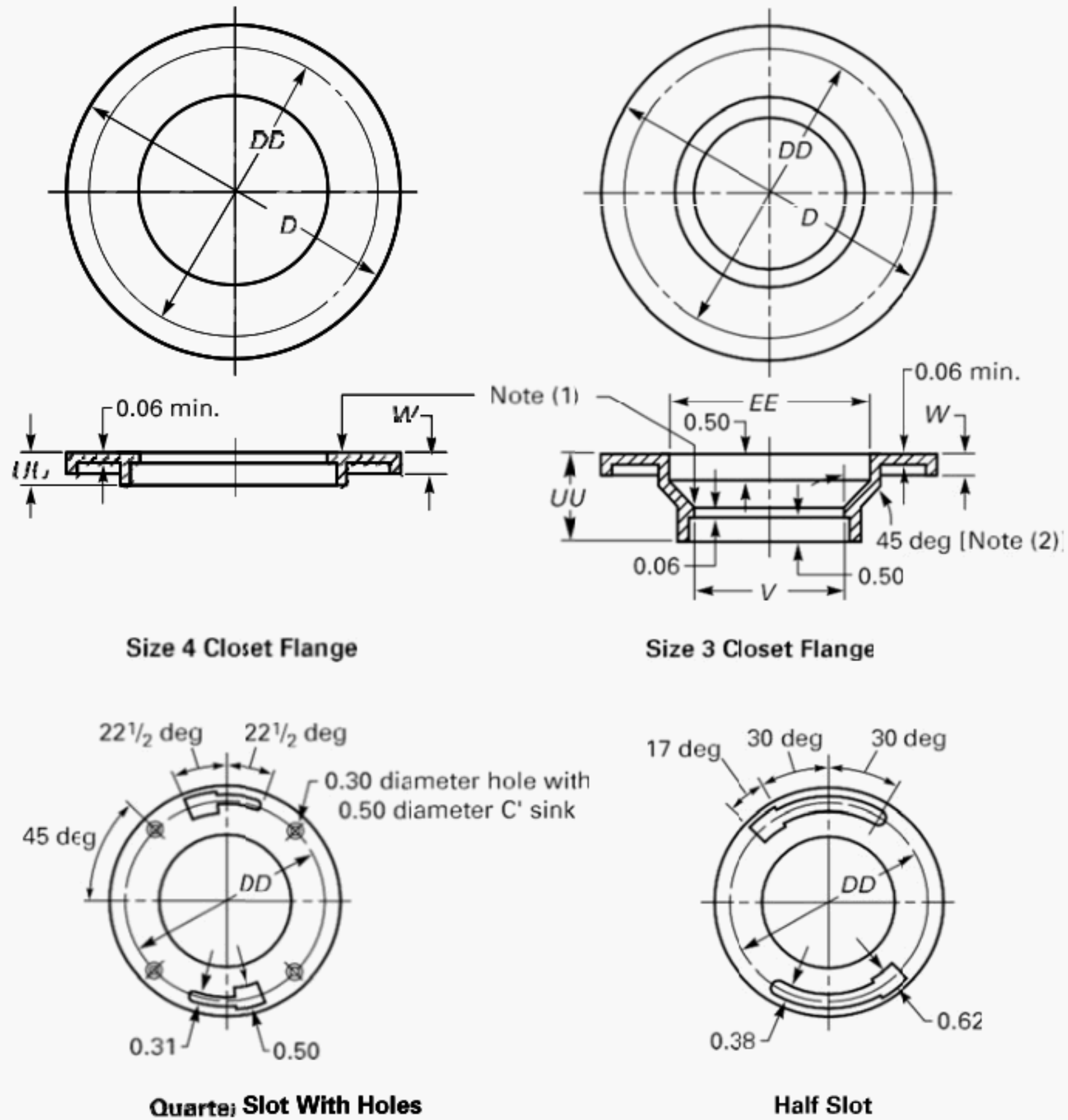

Suggested Slot Arrangements

Nominal Size	D , Min.	DD	EE	UU , Min.	V , Min. [Note (3)]	W
3	6.75	6.0	4.12	1.56	2.94	0.25
4	6.75	6.0	...	0.62	...	0.25

GENERAL NOTE: Dimensions are in inches.

NOTES:

- (1) Tube stop optional.
- (2) 45-deg angle may be extended to face of flange.
- (3) For flange with tube stop.

Table I-12 Dimensions of DWV Trap Adapters

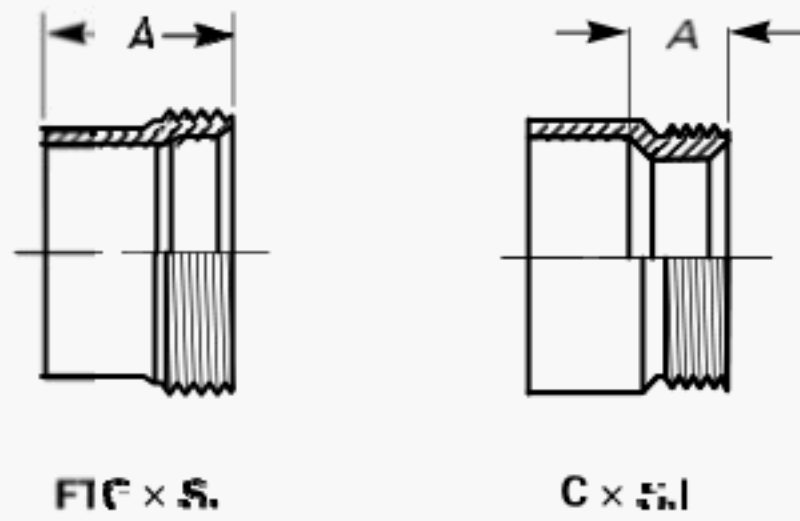

Nominal Size	FTG x SJ, A	C x SJ, A
1¼	1.09	0.50
1½	1.16	0.50
1½ x 1¼	1.19	0.62

GENERAL NOTE: Dimensions are in inches.

Table I-13 Dimensions of DWV Slip-Joint Ends

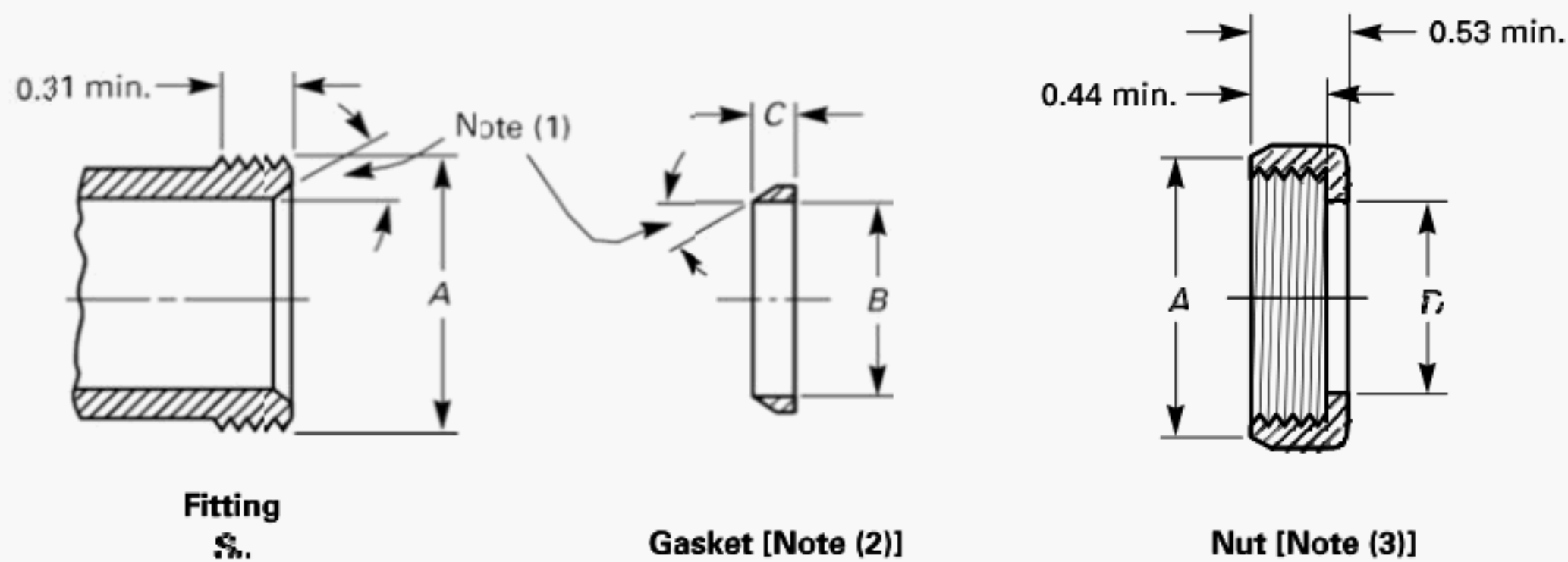

Nominal Size	Diameter of Thread, A	Gasket		Nut
		Nominal Inside Diameter of Gasket, B	Minimum Length of Gasket, C	Nominal Nut Hole Diameter, D
1¼	1¼ NPSM	1.26	0.16	1.28
1½	1½ NPSM	1.51	0.19	1.53

GENERAL NOTE: Dimensions are in inches.

NOTES:

- (1) Angles must be equal.
 (2) Gasket to be pliable, not subject to aging or drying out.
 (3) Nut may be any material specified in [section 8](#) or other suitable nonferrous alloy.

MANDATORY APPENDIX II REFERENCES

Ø17P

The following is a list of publications referenced in this Standard. Unless otherwise specified, the latest edition of ASME publications shall apply. Materials manufactured to other editions of the referenced ASTM standards may be used to manufacture fittings meeting the requirements of this Standard as long as the fitting manufacturer verifies that material meets the requirements of the referenced edition.

ASME B1.20.1, Pipe Threads, General Purpose (Inch)
ASME B16.22, Wrought Copper and Copper Alloy Solder-Joint Pressure Fittings
ASME B16.23, Cast Copper Alloy Solder-Joint Drainage Fittings (DWV)
Publisher: The American Society of Mechanical Engineers (ASME), Two Park Avenue, New York, NY 10016-5990 (www.asme.org)

ASTM A74-16, Standard Specification for Cast Iron Soil Pipe and Fittings
ASTM B88-14, Standard Specification for Seamless Copper Water Tube

ASTM B306-13, Standard Specification for Copper Drainage Tube (DWV)
ASTM E29-13, Standard Practice for Using Significant Digits in Test Data to Determine Conformance With Specifications
Publisher: American Society for Testing and Materials (ASTM International), 100 Barr Harbor Drive, P.O. Box C700, West Conshohocken, PA 19428-2959 (www.astm.org)

ISO 9000:2015, Quality management systems — Fundamentals and vocabulary¹
ISO 9001: 2015, Quality management systems — Requirements¹
ISO 9004:2009, Managing for the sustained success of an organization — A quality management approach¹
Publisher: International Organization for Standardization (ISO), Central Secretariat, Chemin de Blandonnet 8, Case Postale 401, 1214 Vernier, Geneva, Switzerland (www.iso.org)

¹ May also be obtained from American National Standards Institute (ANSI), 25 West 43rd Street, New York, NY 10036.

NONMANDATORY APPENDIX A

QUALITY SYSTEM PROGRAM

The products manufactured in accordance with this Standard shall be produced under a quality system program following the principles of an appropriate standard from the ISO 9000 series.¹ A determination of the need for registration and/or certification of the product manufacturer's quality system program by an independent organization shall be the responsibility of the manufacturer. Detailed documentation demonstrating

program compliance shall be available to the purchaser at the manufacturer's facility. A written, summary description of the program used by the product manufacturer shall be available to the purchaser upon request. The product manufacturer is defined as the entity whose name or trademark appears on the product in accordance with the marking or identification requirements of this Standard.

¹ The series is also available from the American National Standards Institute (ANSI) and the American Society for Quality (ASQ) as American National Standards that are identified by the prefix "Q," replacing the prefix "ISO." Each standard of the series is listed under References in Mandatory Appendix II.

B16 AMERICAN NATIONAL STANDARDS FOR PIPING, PIPE FLANGES, FITTINGS, AND VALVES

B16.1-2015	Gray Iron Pipe Flanges and Flanged Fittings (Classes 25, 125, and 250)
B16.3-2016	Malleable Iron Threaded Fittings: Classes 150 and 300
B16.4-2016	Gray Iron Threaded Fittings: Classes 125 and 250
B16.5-2017	Pipe Flanges and Flanged Fittings NPS ½ Through NPS 24 Metric/Inch Standard
B16.9-2012	Factory-Made Wrought Butt welding Fittings
B16.10-2017	Face-to-Face and End-to-End Dimensions of Valves
B16.11-2016	Forged Fittings, Socket-Welding and Threaded
B16.12-2009 (R2014)	Cast Iron Threaded Drainage Fittings
B16.14-2013	Ferrous Pipe Plugs, Bushings, and Locknuts With Pipe Threads
B16.15-2013	Cast Copper Alloy Threaded Fittings
B16.18-2012	Cast Copper Alloy Solder Joint Pressure Fittings
B16.20-2017	Metallic Gaskets for Pipe Flanges
B16.21-2016	Nonmetallic Flat Gaskets for Pipe Flanges
B16.22-2013	Wrought Copper and Copper Alloy Solder-Joint Pressure Fittings
B16.23-2016	Cast Copper Alloy Solder Joint Drainage Fittings: DWV
B16.24-2016	Cast Copper Alloy Pipe Flanges, Flanged Fittings, and Valves: Classes 150, 300, 600, 900, 1500, and 2500
B16.25-2017	Butt welding Ends
B16.26-2013	Cast Copper Alloy Fittings for Flared Copper Tubes
B16.29-2017	Wrought Copper and Wrought Copper Alloy Solder-Joint Drainage Fittings — DWV
B16.33-2012 (R2017)	Manually Operated Metallic Gas Valves for Use in Gas Piping Systems Up to 175 psi (Sizes NPS ½ Through NPS 2)
B16.34-2017	Valves — Flanged, Threaded, and Welding End
B16.36-2015	Orifice Flanges
B16.38-2012 (R2017)	Large Metallic Valves for Gas Distribution: Manually Operated, NPS 2½ (DN 65) to NPS 12 (DN 300), 125 psig (8.6 bar) Maximum
B16.39-2014	Malleable Iron Threaded Pipe Unions: Classes 150, 250, and 300
B16.40-2013	Manually Operated Thermoplastic Gas Shutoffs and Valves in Gas Distribution Systems
B16.42-2016	Ductile Iron Pipe Flanges and Flanged Fittings: Classes 150 and 300
B16.44-2012 (R2017)	Manually Operated Metallic Gas Valves for Use in Aboveground Piping Systems Up to 5 psi
B16.47-2017	Large Diameter Steel Flanges NPS 26 Through NPS 60 Metric/Inch Standard
B16.48-2015	Line Blanks
B16.49-2017	Factory-Made, Wrought Steel, Butt welding Induction Bends for Transportation and Distribution Systems
B16.50-2013	Wrought Copper and Copper Alloy Braze-Joint Pressure Fittings
B16.51-2013	Copper and Copper Alloy Press-Connect Pressure Fittings

The ASME Publications Catalog shows a complete list of all the Standards published by the Society. For a complimentary catalog, or the latest information about our publications, call 1-800-THE-ASME (1-800-843-2763).

ASME Services

ASME is committed to developing and delivering technical information. At ASME's Customer Care, we make every effort to answer your questions and expedite your orders. Our representatives are ready to assist you in the following areas:

ASME Press	Member Services & Benefits	Public Information
<i>Codes & Standards</i>	Other ASME Programs	Self-Study Courses
Credit Card Orders	Payment Inquiries	Shipping Information
IMechE Publications	Professional Development	Subscriptions/Journals/Magazines
Meetings & Conferences	Short Courses	Symposia Volumes
Member Dues Status	Publications	Technical Papers

How can you reach us? It's easier than ever!

There are four options for making inquiries* or placing orders. Simply mail, phone, fax, or E-mail us and a Customer Care representative will handle your request.

<i>Mail</i>	<i>Call Toll Free</i>	<i>Fax—24 hours</i>	<i>E-Mail—24 hours</i>
ASME	US & Canada: 800-THE-ASME	973-882-1717	customercare@asme.org
150 Clove Road, 6th Floor	(800-843-2763)	973-882-5155	
Little Falls, New Jersey	Mexico: 95-800-THE-ASME		
07424-2139	(95-800-843-2763)		

*Customer Care staff are not permitted to answer inquiries about the technical content of this code or standard. Information as to whether or not technical inquiries are issued to this code or standard is shown on the copyright page. All technical inquiries must be submitted in writing to the staff secretary. Additional procedures for inquiries may be listed within.

ASME B16.29-2017

ISBN 978-0-7918-7188-1



9 780791 871881

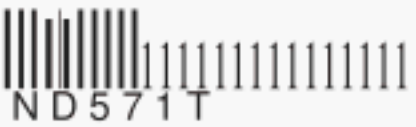

ND571T